



STANDARD ADAPTERS

Straight Male Adapter Shanks For Female Caps

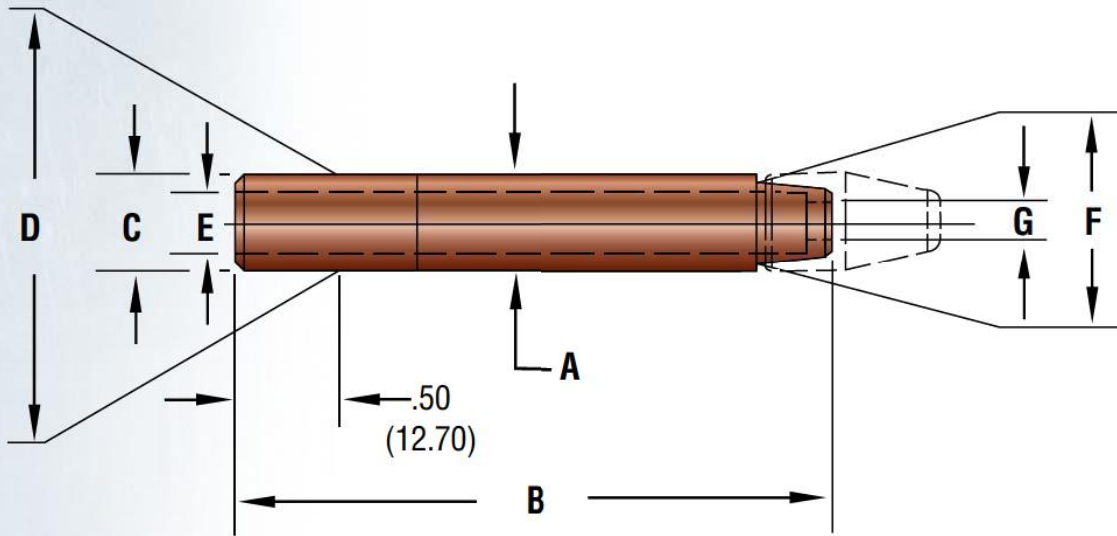

FIGURE 3-1 (Material RWMA Class 2 & 3)

- Dimensions Shown Are: inches (mm).
- See pg. 3-2 for part number chart and pg. 2-1 For Caps.

KEY TO ITEM NUMBERS

- CLF -** Adapter Designation
- 2 or 3 -** RWMA Alloy Class
- 4 Thru 7 -** RW Taper Number
- 05 Thru 16 -** Overall Length in .25 (6.35) Increments
- T -** Thru Water Hole
Delete "T" If Blind Hole Is Required

EXAMPLE:
MALE ADAPTER, CLASS 2, RW 6 TAPER, 2.50 (63.50) O.A.L., THRU WATER HOLE

• **CLF - 2610T**

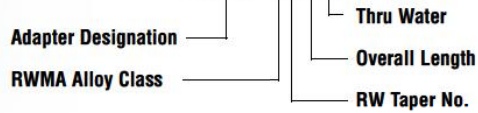



STANDARD ADAPTERS

Straight Male Adapter Shanks For Female Caps

Item No.	DIMENSIONS						
	A	B	C	D	E	F	G
	CLASS 2 Major Diameter	Shank Overall Length	Minor Taper Diameter	Gauging Taper Diameter	Water Hole Diameter	Cap End Taper Diameter	Taper Water Hole Diameter
CLF-2405T	.482 (12.24)	1.25 (31.75)	.438 (11.13)	.463 (11.76)	.28 (7.14)	.402 (10.21)	.25 (6.35)
CLF-2406T	.482 (12.24)	1.50 (38.10)	.438 (11.13)	.463 (11.76)	.28 (7.14)	.402 (10.21)	.25 (6.35)
CLF-2407T	.482 (12.24)	1.75 (44.45)	.438 (11.13)	.463 (11.76)	.28 (7.14)	.402 (10.21)	.25 (6.35)
CLF-2408T	.482 (12.24)	2.00 (50.80)	.438 (11.13)	.463 (11.76)	.28 (7.14)	.402 (10.21)	.25 (6.35)
CLF-2409T	.482 (12.24)	2.25 (57.15)	.438 (11.13)	.463 (11.76)	.28 (7.14)	.402 (10.21)	.25 (6.35)
CLF-2410T	.482 (12.24)	2.50 (63.50)	.438 (11.13)	.463 (11.76)	.28 (7.14)	.402 (10.21)	.25 (6.35)
CLF-2411T	.482 (12.24)	2.75 (69.85)	.438 (11.13)	.463 (11.76)	.28 (7.14)	.402 (10.21)	.25 (6.35)
CLF-2412T	.482 (12.24)	3.00 (76.20)	.438 (11.13)	.463 (11.76)	.28 (7.14)	.402 (10.21)	.25 (6.35)
CLF-2413T	.482 (12.24)	3.25 (82.55)	.438 (11.13)	.463 (11.76)	.28 (7.14)	.402 (10.21)	.25 (6.35)
CLF-2414T	.482 (12.24)	3.50 (88.90)	.438 (11.13)	.463 (11.76)	.28 (7.14)	.402 (10.21)	.25 (6.35)
CLF-2415T	.482 (12.24)	3.75 (95.25)	.438 (11.13)	.463 (11.76)	.28 (7.14)	.402 (10.21)	.25 (6.35)
CLF-2416T	.482 (12.24)	4.00 (101.60)	.438 (11.13)	.463 (11.76)	.28 (7.14)	.402 (10.21)	.25 (6.35)
CLF-2506T	.625 (15.88)	1.43 (36.32)	.588 (14.94)	.613 (15.57)	.34 (8.73)	.502 (12.75)	.265 (6.73)
CLF-2507T	.625 (15.88)	1.68 (42.67)	.588 (14.94)	.613 (15.57)	.34 (8.73)	.502 (12.75)	.265 (6.73)
CLF-2508T	.625 (15.88)	1.93 (49.02)	.588 (14.94)	.613 (15.57)	.34 (8.73)	.502 (12.75)	.265 (6.73)
CLF-2509T	.625 (15.88)	2.18 (55.37)	.588 (14.94)	.613 (15.57)	.34 (8.73)	.502 (12.75)	.265 (6.73)
CLF-2510T	.625 (15.88)	2.43 (61.72)	.588 (14.94)	.613 (15.57)	.34 (8.73)	.502 (12.75)	.265 (6.73)
CLF-2511T	.625 (15.88)	2.68 (68.02)	.588 (14.94)	.613 (15.57)	.34 (8.73)	.502 (12.75)	.265 (6.73)
CLF-2512T	.625 (15.88)	2.93 (74.42)	.588 (14.94)	.613 (15.57)	.34 (8.73)	.502 (12.75)	.265 (6.73)
CLF-2513T	.625 (15.88)	3.18 (80.77)	.588 (14.94)	.613 (15.57)	.34 (8.73)	.502 (12.75)	.265 (6.73)
CLF-2514T	.625 (15.88)	3.43 (87.12)	.588 (14.94)	.613 (15.57)	.34 (8.73)	.502 (12.75)	.265 (6.73)
CLF-2515T	.625 (15.88)	3.68 (93.47)	.588 (14.94)	.613 (15.57)	.34 (8.73)	.502 (12.75)	.265 (6.73)
CLF-2516T	.625 (15.88)	3.93 (99.82)	.588 (14.94)	.613 (15.57)	.34 (8.73)	.502 (12.75)	.265 (6.73)
CLF-2608T	.750 (19.05)	2.00 (50.80)	.706 (17.93)	.731 (18.57)	.38 (9.53)	.633 (16.08)	.343 (8.71)
CLF-2610T	.750 (19.05)	2.50 (63.50)	.706 (17.93)	.731 (18.57)	.38 (9.53)	.633 (16.08)	.343 (8.71)
CLF-2612T	.750 (19.05)	3.00 (76.20)	.706 (17.93)	.731 (18.57)	.38 (9.53)	.633 (16.08)	.343 (8.71)
CLF-2614T	.750 (19.05)	3.50 (88.90)	.706 (17.93)	.731 (18.57)	.38 (9.53)	.633 (16.08)	.343 (8.71)
CLF-2616T	.750 (19.05)	4.00 (101.60)	.706 (17.93)	.731 (18.57)	.38 (9.53)	.633 (16.08)	.343 (8.71)
CLF-2708T	.875 (22.23)	2.00 (50.80)	.819 (20.80)	.844 (21.44)	.38 (9.53)	.633 (16.08)	.343 (8.71)
CLF-2710T	.875 (22.23)	2.50 (63.50)	.819 (20.80)	.844 (21.44)	.38 (9.53)	.633 (16.08)	.343 (8.71)
CLF-2712T	.875 (22.23)	3.00 (76.20)	.819 (20.80)	.844 (21.44)	.38 (9.53)	.633 (16.08)	.343 (8.71)
CLF-2714T	.875 (22.23)	3.50 (88.90)	.819 (20.80)	.844 (21.44)	.38 (9.53)	.633 (16.08)	.343 (8.71)
CLF-2716T	.875 (22.23)	4.00 (101.60)	.819 (20.80)	.844 (21.44)	.38 (9.53)	.633 (16.08)	.343 (8.71)



STANDARD ADAPTERS

Straight Female Adapter Shanks For Male Caps

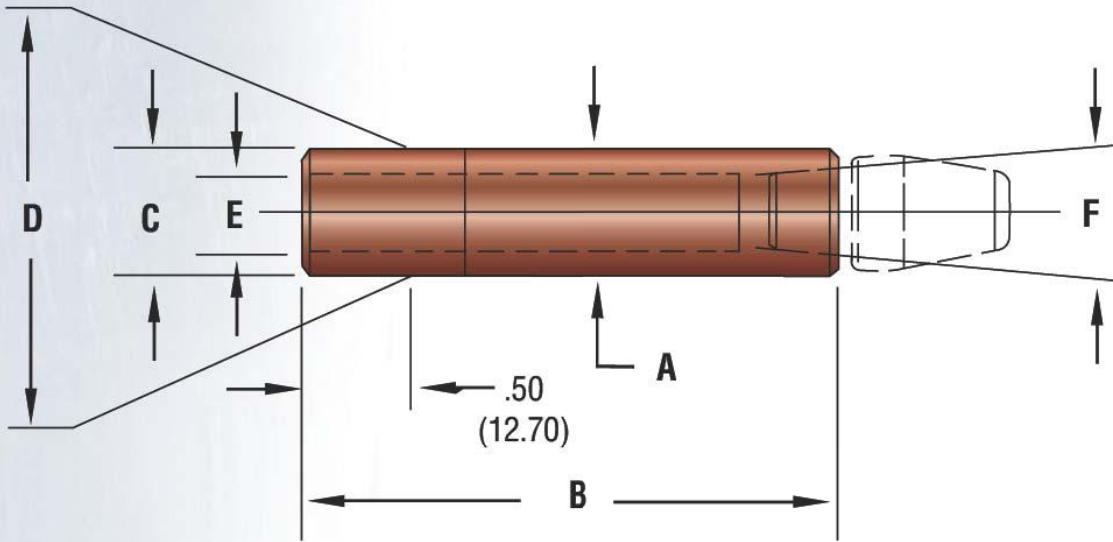

FIGURE 3-3 (Material RWMA Class 2 & 3)

- Dimensions Shown Are: inches (mm).
- See pg. 2-2 For Caps.

FOR ALL OTHER ITEMS:

- Check Key To Item Numbers For Availability
- Use Example For Ordering Available Items

KEY TO ITEM NUMBERS

- WG -** Adapter Designation
- 2 or 3 -** RWMA Alloy Class
- 4 Thru 7 -** RW Taper Number
- 05 Thru 16 -** Overall Length in .25 (6.35) Increments

EXAMPLE:

FEMALE ADAPTER, CLASS 3, RW 4 TAPER, 1.25 (31.75) O.A.L.

• **WG - 3405**

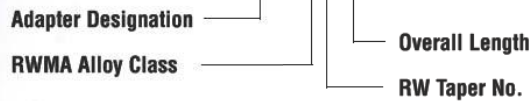



STANDARD ADAPTERS

Straight Female Adapter Shanks For Male Caps

ITEM NO.	DIMENSIONS					
	A	B	C	D	E	F
	CLASS 2 Major Diameter	Shank Overall Length	Minor Taper Diameter	Gauging Taper Diameter	Water Hole Diameter	Major Female Taper Diameter
WG-2405	.482 (12.24)	1.25 (31.75)	.438 (11.13)	.463 (11.76)	.28 (7.14)	.375 (9.53)
WG-2406	.482 (12.24)	1.50 (38.10)	.438 (11.13)	.463 (11.76)	.28 (7.14)	.375 (9.53)
WG-2407	.482 (12.24)	1.75 (44.45)	.438 (11.13)	.463 (11.76)	.28 (7.14)	.375 (9.53)
WG-2408	.482 (12.24)	2.00 (50.80)	.438 (11.13)	.463 (11.76)	.28 (7.14)	.375 (9.53)
WG-2409	.482 (12.24)	2.25 (57.15)	.438 (11.13)	.463 (11.76)	.28 (7.14)	.375 (9.53)
WG-2410	.482 (12.24)	2.50 (63.50)	.438 (11.13)	.463 (11.76)	.28 (7.14)	.375 (9.53)
WG-2411	.482 (12.24)	2.75 (69.85)	.438 (11.13)	.463 (11.76)	.28 (7.14)	.375 (9.53)
WG-2412	.482 (12.24)	3.00 (76.20)	.438 (11.13)	.463 (11.76)	.28 (7.14)	.375 (9.53)
WG-2413	.482 (12.24)	3.25 (82.55)	.438 (11.13)	.463 (11.76)	.28 (7.14)	.375 (9.53)
WG-2414	.482 (12.24)	3.50 (88.90)	.438 (11.13)	.463 (11.76)	.28 (7.14)	.375 (9.53)
WG-2415	.482 (12.24)	3.75 (95.25)	.438 (11.13)	.463 (11.76)	.28 (7.14)	.375 (9.53)
WG-2416	.482 (12.24)	4.00 (101.60)	.438 (11.13)	.463 (11.76)	.28 (7.14)	.375 (9.53)
WG-2505	.625 (15.88)	1.25 (31.75)	.588 (14.94)	.613 (15.57)	.38 (9.53)	.415 (10.54)
WG-2506	.625 (15.88)	1.50 (38.10)	.588 (14.94)	.613 (15.57)	.38 (9.53)	.415 (10.54)
WG-2507	.625 (15.88)	1.75 (44.45)	.588 (14.94)	.613 (15.57)	.38 (9.53)	.415 (10.54)
WG-2508	.625 (15.88)	2.00 (50.80)	.588 (14.94)	.613 (15.57)	.38 (9.53)	.415 (10.54)
WG-2509	.625 (15.88)	2.25 (57.15)	.588 (14.94)	.613 (15.57)	.38 (9.53)	.415 (10.54)
WG-2510	.625 (15.88)	2.50 (63.50)	.588 (14.94)	.613 (15.57)	.38 (9.53)	.415 (10.54)
WG-2511	.625 (15.88)	2.75 (69.85)	.588 (14.94)	.613 (15.57)	.38 (9.53)	.415 (10.54)
WG-2512	.625 (15.88)	3.00 (76.20)	.588 (14.94)	.613 (15.57)	.38 (9.53)	.415 (10.54)
WG-2513	.625 (15.88)	3.25 (82.55)	.588 (14.94)	.613 (15.57)	.38 (9.53)	.415 (10.54)
WG-2514	.625 (15.88)	3.50 (88.90)	.588 (14.94)	.613 (15.57)	.38 (9.53)	.415 (10.54)
WG-2515	.625 (15.88)	3.75 (95.25)	.588 (14.94)	.613 (15.57)	.38 (9.53)	.415 (10.54)
WG-2516	.625 (15.88)	4.00 (101.60)	.588 (14.94)	.613 (15.57)	.38 (9.53)	.415 (10.54)
WG-2608	.750 (19.05)	2.00 (50.80)	.706 (17.93)	.731 (18.57)	.44 (11.11)	.501 (12.73)
WG-2610	.750 (19.05)	2.50 (63.50)	.706 (17.93)	.731 (18.57)	.44 (11.11)	.501 (12.73)
WG-2612	.750 (19.05)	3.00 (76.20)	.706 (17.93)	.731 (18.57)	.44 (11.11)	.501 (12.73)
WG-2614	.750 (19.05)	3.50 (88.90)	.706 (17.93)	.731 (18.57)	.44 (11.11)	.501 (12.73)
WG-2616	.750 (19.05)	4.00 (101.60)	.706 (17.93)	.731 (18.57)	.44 (11.11)	.501 (12.73)
WG-2708	.875 (22.23)	2.00 (50.80)	.819 (20.80)	.844 (21.44)	.50 (12.70)	.613 (15.57)
WG-2710	.875 (22.23)	2.50 (63.50)	.819 (20.80)	.844 (21.44)	.50 (12.70)	.613 (15.57)
WG-2712	.875 (22.23)	3.00 (76.20)	.819 (20.80)	.844 (21.44)	.50 (12.70)	.613 (15.57)
WG-2714	.875 (22.23)	3.50 (88.90)	.819 (20.80)	.844 (21.44)	.50 (12.70)	.613 (15.57)
WG-2716	.875 (22.23)	4.00 (101.60)	.819 (20.80)	.844 (21.44)	.50 (12.70)	.613 (15.57)

• ADDITIONAL LENGTHS ARE AVAILABLE UPON REQUEST.



STANDARD ADAPTERS

Offset Male Adapter Shanks For Female Caps

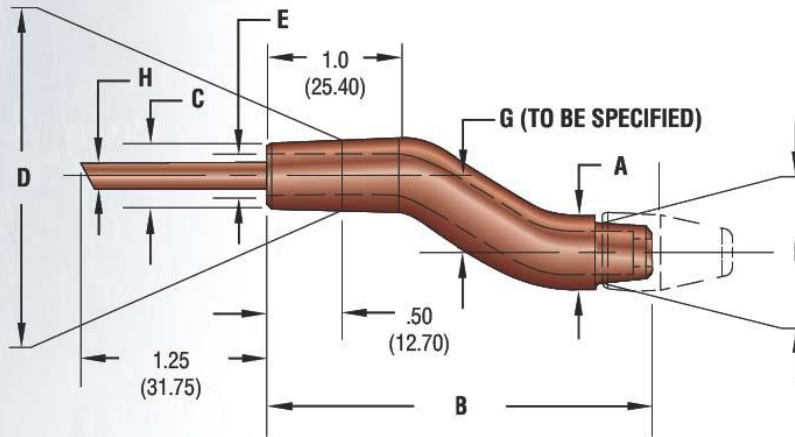

- Dimensions Shown Are: inches (mm).
- See pg. 2-1 For Caps.

FIGURE 3-4 (Material RWMA Class 2 & 3)

ITEM NO.	DIMENSIONS							
	A	B	C	D	E	F	G	H
CLASS 2	Major Diameter	Shank Overall Length	Minor Taper Diameter	Gauging Taper Diameter	Water Hole Diameter	Cap End Taper Diameter	Offset	Water Tube Diameter
CLF-2410-04T	.482 (12.24)	2.50 (63.50)	.438 (11.13)	.463 (11.76)	.28 (7.14)	.402 (10.21)	.25 (6.35)	.19 (4.76)
CLF-2411-04T	.482 (12.24)	2.75 (69.85)	.438 (11.13)	.463 (11.76)	.28 (7.14)	.402 (10.21)	.25 (6.35)	.19 (4.76)
CLF-2412-04T	.482 (12.24)	3.00 (76.20)	.438 (11.13)	.463 (11.76)	.28 (7.14)	.402 (10.21)	.25 (6.35)	.19 (4.76)
CLF-2413-04T	.482 (12.24)	3.25 (82.55)	.438 (11.13)	.463 (11.76)	.28 (7.14)	.402 (10.21)	.25 (6.35)	.19 (4.76)
CLF-2410-08T	.482 (12.24)	2.50 (63.50)	.438 (11.13)	.463 (11.76)	.28 (7.14)	.402 (10.21)	.50 (12.70)	.19 (4.76)
CLF-2411-08T	.482 (12.24)	2.75 (69.85)	.438 (11.13)	.463 (11.76)	.28 (7.14)	.402 (10.21)	.50 (12.70)	.19 (4.76)
CLF-2412-08T	.482 (12.24)	3.00 (76.20)	.438 (11.13)	.463 (11.76)	.28 (7.14)	.402 (10.21)	.50 (12.70)	.19 (4.76)
CLF-2413-08T	.482 (12.24)	3.25 (82.55)	.588 (14.94)	.463 (11.76)	.28 (7.14)	.402 (10.21)	.50 (12.70)	.19 (4.76)
CLF-2510-04T	.625 (15.88)	2.50 (63.50)	.588 (14.94)	.613 (15.57)	.34 (8.73)	.502 (12.75)	.25 (6.35)	.25 (6.35)
CLF-2511-04T	.625 (15.88)	2.75 (69.85)	.588 (14.94)	.613 (15.57)	.34 (8.73)	.502 (12.75)	.25 (6.35)	.25 (6.35)
CLF-2512-04T	.625 (15.88)	3.00 (76.20)	.588 (14.94)	.613 (15.57)	.34 (8.73)	.502 (12.75)	.25 (6.35)	.25 (6.35)
CLF-2513-04T	.625 (15.88)	3.25 (82.55)	.588 (14.94)	.613 (15.57)	.34 (8.73)	.502 (12.75)	.25 (6.35)	.25 (6.35)
CLF-2510-08T	.625 (15.88)	2.50 (63.50)	.588 (14.94)	.613 (15.57)	.34 (8.73)	.502 (12.75)	.50 (12.70)	.25 (6.35)
CLF-2511-08T	.625 (15.88)	2.75 (69.85)	.588 (14.94)	.613 (15.57)	.34 (8.73)	.502 (12.75)	.50 (12.70)	.25 (6.35)
CLF-2512-08T	.625 (15.88)	3.00 (76.20)	.588 (14.94)	.613 (15.57)	.34 (8.73)	.502 (12.75)	.50 (12.70)	.25 (6.35)
CLF-2513-08T	.625 (15.88)	3.25 (82.55)	.588 (14.94)	.613 (15.57)	.34 (8.73)	.502 (12.75)	.50 (12.70)	.25 (6.35)

FOR ALL OTHER ITEMS:

- Check Key To Item Numbers For Availability
- Use Example For Ordering Available Items

• ADDITIONAL LENGTHS ARE AVAILABLE UPON REQUEST.

EXAMPLE:

MALE ADAPTER, CLASS 3,
RW 4 TAPER, 2.50 (63.50) O.A.L., .25 (6.35) OFFSET, THRU WATER HOLE

• CLF - 3410 - 04T

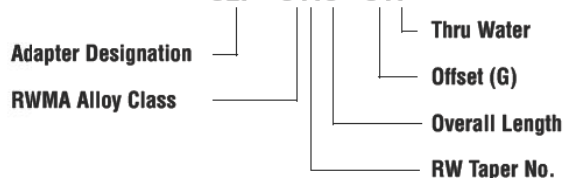

KEY TO ITEM NUMBERS

- CLF - Adapter Designation
- 2 or 3 - RWMA Alloy Class
- 4 Thru 6 - RW Taper Number
- 10 Thru 20 - Overall Length in .25 (6.35) Increments
- 04 Thru 16 - Offset in 1/16 (1.59) Increments
- T - Thru Water Hole
- Delete "T" If Blind Hole Is Required

STANDARD ADAPTERS

Offset Female Adapter Shanks for Male Caps

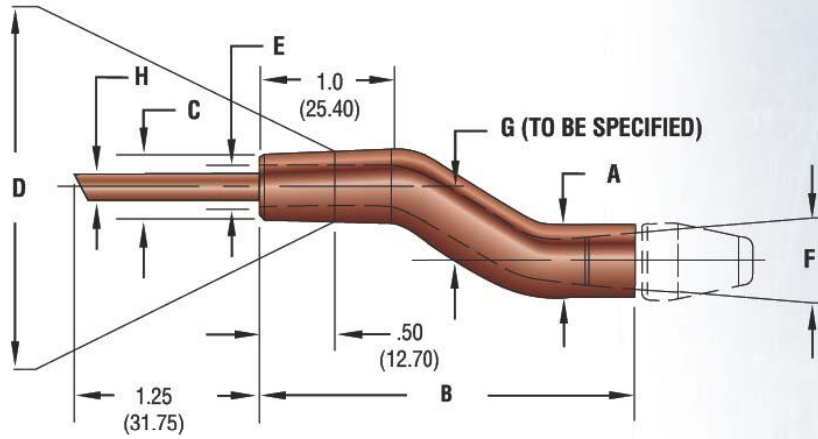

- Dimensions Shown Are: inches (mm).
- See pg. 2-2 For Caps.

FIGURE 3-5 (Material RWMA Class 2 & 3)

ITEM NO.	DIMENSIONS							
	A	B	C	D	E	F	G	H
CLASS 2	Major Diameter	Shank Overall Length	Minor Taper Diameter	Gauging Taper Diameter	Water Hole Diameter	Cap End Taper Diameter	Offset	Water Tube Diameter
WG-2410-04	.482 (12.24)	2.50 (63.50)	.438 (11.13)	.463 (11.76)	.28 (7.14)	.375 (9.53)	.25 (6.35)	.19 (4.76)
WG-2411-04	.482 (12.24)	2.75 (69.85)	.438 (11.13)	.463 (11.76)	.28 (7.14)	.375 (9.53)	.25 (6.35)	.19 (4.76)
WG-2412-04	.482 (12.24)	3.00 (76.20)	.438 (11.13)	.463 (11.76)	.28 (7.14)	.375 (9.53)	.25 (6.35)	.19 (4.76)
WG-2413-04	.482 (12.24)	3.25 (82.55)	.438 (11.13)	.463 (11.76)	.28 (7.14)	.375 (9.53)	.25 (6.35)	.19 (4.76)
WG-2410-08	.482 (12.24)	2.50 (63.50)	.438 (11.13)	.463 (11.76)	.28 (7.14)	.375 (9.53)	.50 (12.70)	.19 (4.76)
WG-2411-08	.482 (12.24)	2.75 (69.85)	.438 (11.13)	.463 (11.76)	.28 (7.14)	.375 (9.53)	.50 (12.70)	.19 (4.76)
WG-2412-08	.482 (12.24)	3.00 (76.20)	.438 (11.13)	.463 (11.76)	.28 (7.14)	.375 (9.53)	.50 (12.70)	.19 (4.76)
WG-2413-08	.482 (12.24)	3.25 (82.55)	.438 (11.13)	.463 (11.76)	.28 (7.14)	.375 (9.53)	.50 (12.70)	.19 (4.76)
WG-2510-04	.625 (15.88)	2.50 (63.50)	.588 (14.94)	.613 (15.57)	.38 (9.65)	.415 (10.54)	.25 (6.35)	.25 (6.35)
WG-2511-04	.625 (15.88)	2.75 (69.85)	.588 (14.94)	.613 (15.57)	.38 (9.65)	.415 (10.54)	.25 (6.35)	.25 (6.35)
WG-2512-04	.625 (15.88)	3.00 (76.20)	.588 (14.94)	.613 (15.57)	.38 (9.65)	.415 (10.54)	.25 (6.35)	.25 (6.35)
WG-2513-04	.625 (15.88)	3.25 (82.55)	.588 (14.94)	.613 (15.57)	.38 (9.65)	.415 (10.54)	.25 (6.35)	.25 (6.35)
WG-2510-08	.625 (15.88)	2.50 (63.50)	.588 (14.94)	.613 (15.57)	.38 (9.65)	.415 (10.54)	.50 (12.70)	.25 (6.35)
WG-2511-08	.625 (15.88)	2.75 (69.85)	.588 (14.94)	.613 (15.57)	.38 (9.65)	.415 (10.54)	.50 (12.70)	.25 (6.35)
WG-2512-08	.625 (15.88)	3.00 (76.20)	.588 (14.94)	.613 (15.57)	.38 (9.65)	.415 (10.54)	.50 (12.70)	.25 (6.35)
WG-2513-08	.625 (15.88)	3.25 (82.55)	.588 (14.94)	.613 (15.57)	.38 (9.65)	.415 (10.54)	.50 (12.70)	.25 (6.35)

FOR ALL OTHER ITEMS:

- Check Key To Item Numbers For Availability
- Use Example For Ordering Available Items

• ADDITIONAL LENGTHS ARE AVAILABLE UPON REQUEST.

EXAMPLE:

**FEMALE ADAPTER, CLASS 2,
RW 5 TAPER, 3.25 (82.55) O.A.L., 1.0 (25.40) OFFSET.**

• **WG - 2513 - 16**

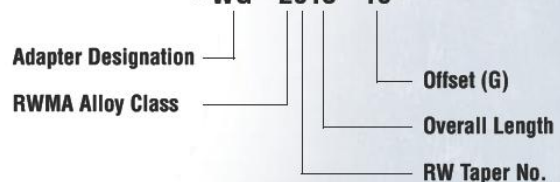

KEY TO ITEM NUMBERS

- WG -** Adapter Designation
- 2 or 3 -** RWMA Alloy Class
- 4 Thru 6 -** RW Taper Number
- 10 Thru 20 -** Overall Length
in .25 (6.35) Increments
- 04 Thru 16 -** Offset in 1/16 (1.59) Increments



STANDARD ADAPTERS

Single Bend Male Adapter Shanks For Female Caps

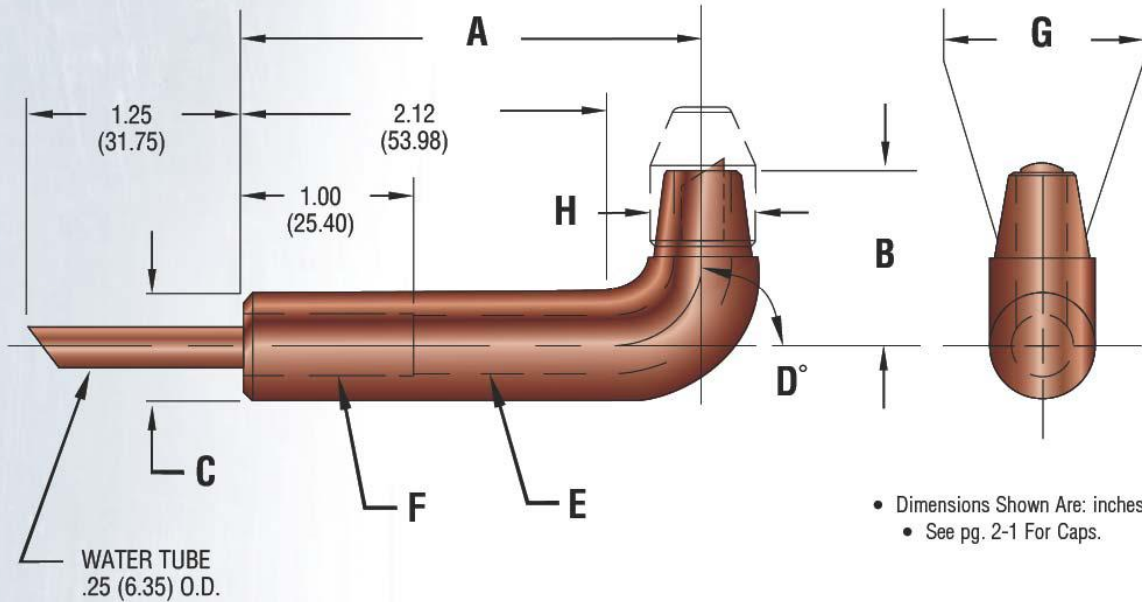

FIGURE 3-6 (Material RWMA Class 3)

DIMENSION CHARTS

C - DIAMETER DIAMETER CODE	.625 (15.88)	.750 (19.05)	.88 (22.35)
A - OVERALL LENGTH	5	6	7
B - OFFSET	AS CODED		
D - ANGLE	AS CODED		

H - CAP SIZE	.500 (12.70)	.625 (15.88)	.750 (19.05)
E - HOLE DIAMETER	.28 (7.11)	.31 (7.87)	.34 (8.64)
F - HOLE DIAMETER	.38 (9.65)	.38 (9.65)	.38 (9.65)
G - TAPER DIAMETER	.402 (10.21)	.502 (12.75)	.633 (16.08)

• TO ORDER YOUR SPECIALS USE CODING CHART - SEE PG. 3-8

STANDARD ADAPTERS

Single Bend Male Adapter Shanks For Female Caps

EXAMPLE EXPLANATION CODING

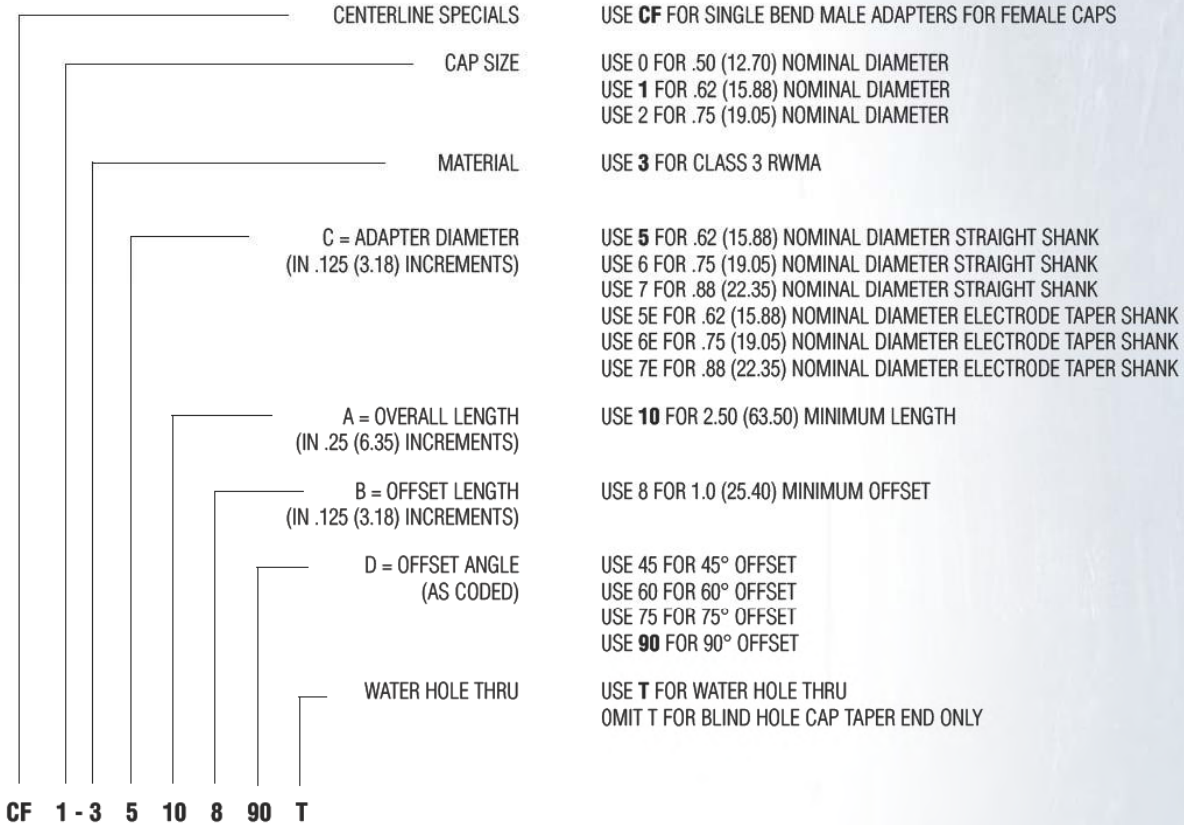

**SAMPLE
TYPICAL CAP ADAPTER CODING**

CAP ADAPTER WATER HOLE WILL BE DRILLED THRU
CAP ADAPTER OFFSET ANGLE WILL BE 90°
CAP ADAPTER OFFSET WILL BE 1.0 (25.40) LONG
CAP ADAPTER WILL BE 2.50 (63.50) LONG
CAP ADAPTER WILL HAVE .62 (15.88) DIAMETER
CAP ADAPTER WILL BE MADE OF CLASS 3 RWMA MATERIAL
CAP ADAPTER WILL HAVE A STRAIGHT SHANK
CAP ADAPTER WILL BE SINGLE BEND MALE FOR FEMALE CAPS

EXAMPLE:

• **CF1-3510890T**

• Dimensions Shown Are: inches (mm)



STANDARD ADAPTERS

Single Bend Female Adapter Shanks For Male Caps

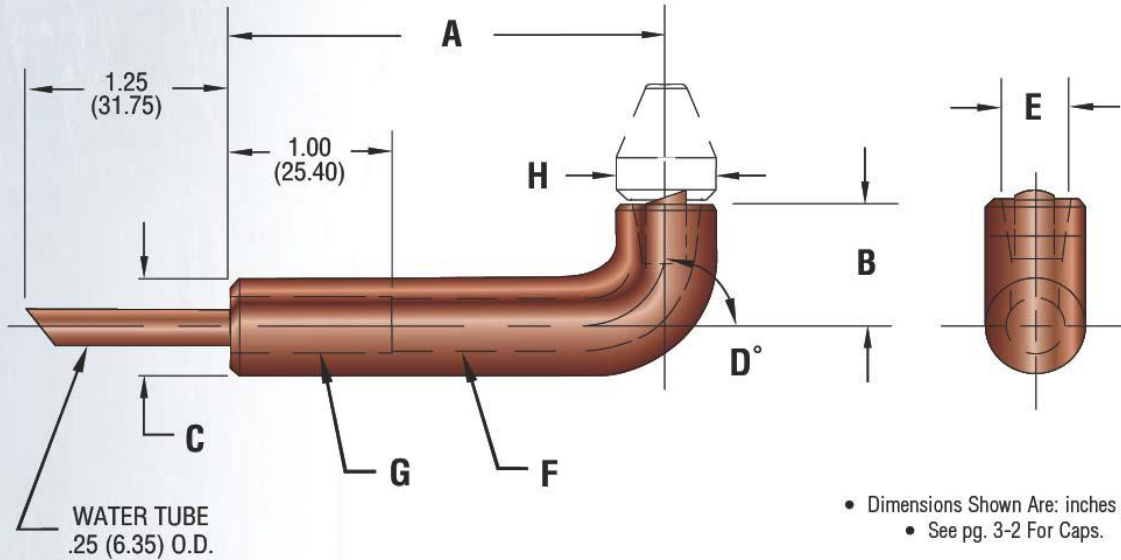

FIGURE 3-7 (Material RWMA Class 3)

DIMENSION CHARTS

C - DIAMETER DIAMETER CODE	.625 (15.88)	.750 (19.05)	.875 (22.23)	1.00 (25.40)
	5	6	7	8
A - OVERALL LENGTH	AS CODED			
B - OFFSET	AS CODED			
D - DIAMETER	AS CODED			

H - CAP SIZE	.500 (12.70)	.625 (15.88)	.750 (19.05)	.875 (22.23)
E - TAPER DIAMETER	.374 (9.50)	.414 (10.52)	.500 (12.70)	.613 (15.57)
F - HOLE DIAMETER	.28 (7.11)	.34 (8.64)	.44 (11.18)	.50 (12.70)
G - HOLE DIAMETER	.38 (9.65)	.38 (9.65)	.44 (11.18)	.50 (12.70)

• TO ORDER YOUR SPECIALS USE CODING CHART - SEE PG. 3-10

STANDARD ADAPTERS

Single Bend Female Adapter Shanks For Male Caps

EXAMPLE EXPLANATION CODING

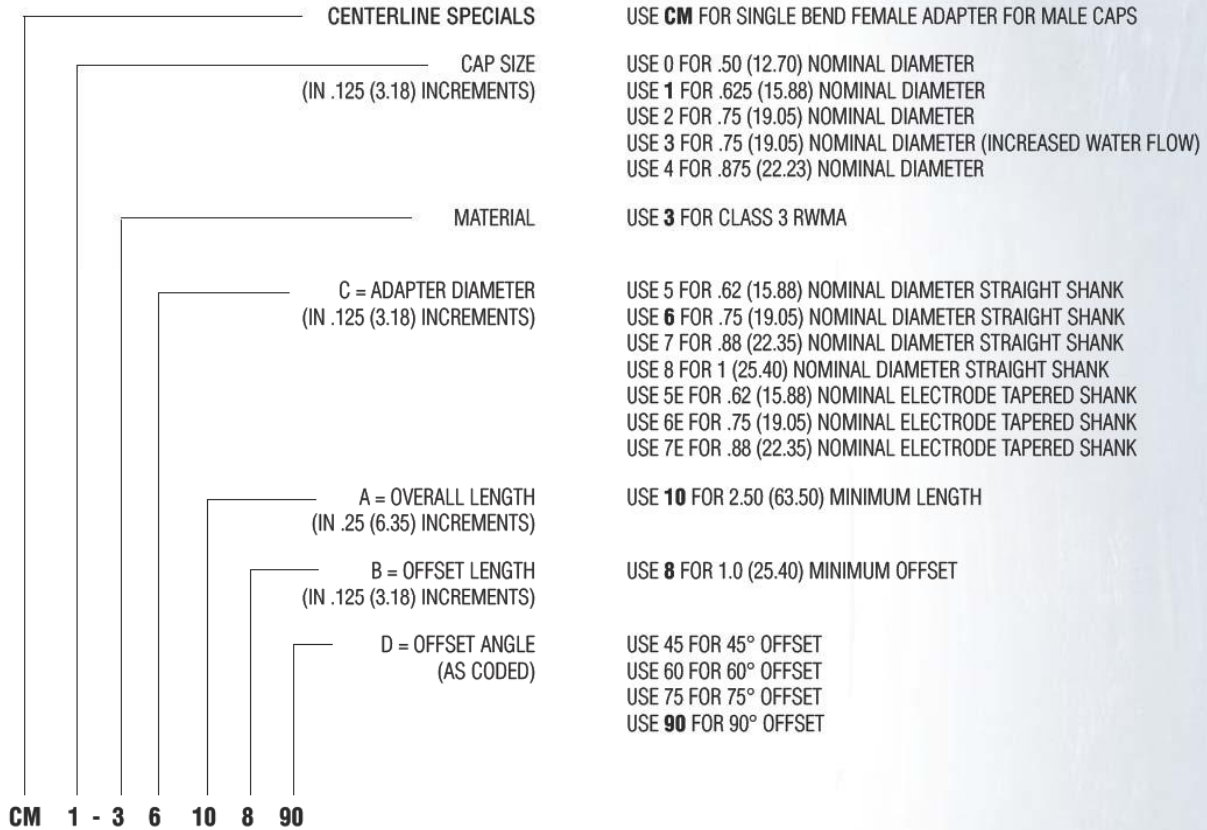

**SAMPLE
TYPICAL CAP ADAPTER CODING**

CAP ADAPTER OFFSET ANGLE WILL BE 90°
CAP ADAPTER OFFSET WILL BE 1.0 (25.40) LONG
CAP ADAPTER WILL BE 2.50 (63.50) LONG
CAP ADAPTER WILL HAVE .62 (15.88) DIAMETER
CAP ADAPTER WILL BE MADE OF CLASS 3 RWMA MATERIAL
CAP ADAPTER WILL HAVE A STRAIGHT SHANK
CAP ADAPTER WILL BE SINGLE BEND FEMALE FOR MALE CAPS

EXAMPLE:

• **CM1-3610690**

• Dimensions Shown Are: inches (mm)



STANDARD ADAPTERS

J Shape Cap Adapters

EXAMPLE:

- CL JA5-35-10166M

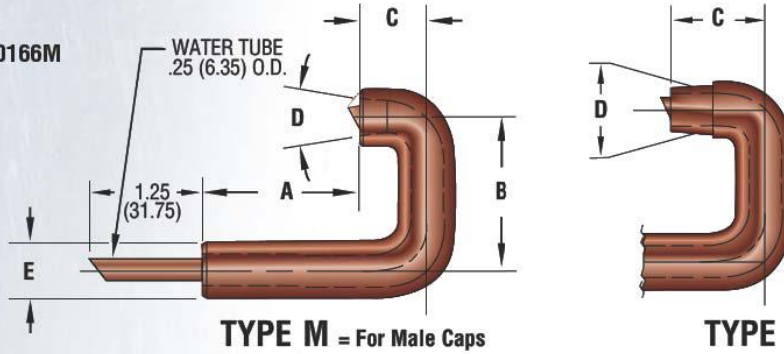

Minimum "C" Dim.

- Type M = .75 (19.05)
- Type F = 1.00 (25.40)

FIGURE 3-8 (Material RWMA Class 3)

- Dimensions Shown Are: inches (mm).
- See pg. 2-1 & 2-2 For Caps

EXAMPLE EXPLANATION CODING

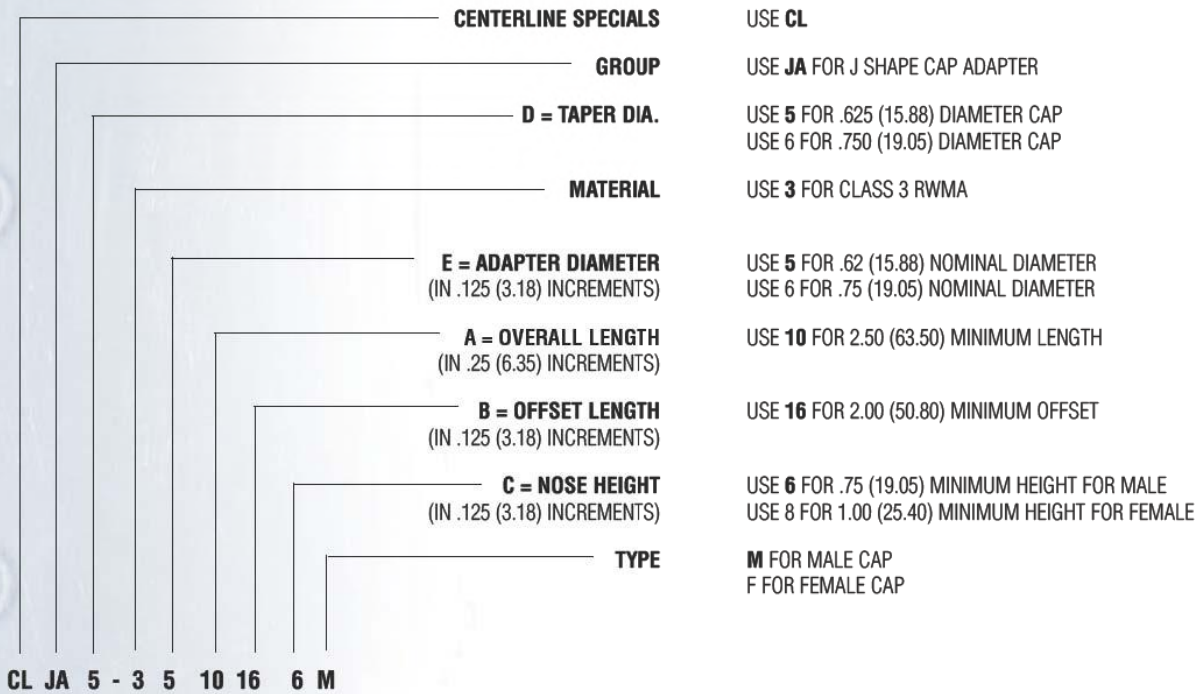

SAMPLE TYPICAL J SHAPE CAP ADAPTER CODING

- CAP ADAPTER TYPE WILL BE FOR MALE CAPS
- CAP ADAPTER NOSE WILL BE .75 (19.05) HIGH
- CAP ADAPTER OFFSET WILL BE 2.00 (50.80) LONG
- CAP ADAPTER WILL BE 2.50 (63.50) LONG
- CAP ADAPTER WILL HAVE .62 (15.88) DIAMETER
- CAP ADAPTER WILL BE MADE OF CLASS 3 RWMA MATERIAL
- CAP ADAPTER NOSE WILL BE .625 (15.88) DIAMETER CAP TAPER
- J SHAPE CAP ADAPTER

STANDARD ADAPTERS

CenterLine Hex Adapters
Straight Thread

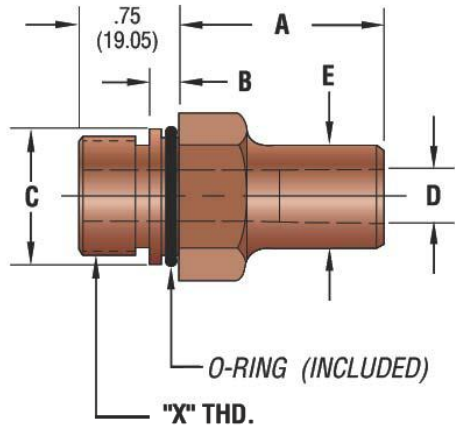

TAPER NO.	D	Minimum A		
		7/8-14	1-12	1-1/4-12
#4RW	0.463 (11.76)	0.25	0.25	0.25
#5RW	0.625 (15.88)	0.25	0.25	0.25
#6RW	0.750 (19.05)	1.13	0.25	0.25
#7RW	0.875 (22.35)	1.38	1.25	0.25

FIGURE 3-9

• Dimensions Shown Are: inches (mm).

THREAD	"X"	B	C	HEX	O-RING	E
7/8-14	87	0.25 (6.35)	1 (25.40)	1-1/4	SLORD-117	1.22
1-12	10	0.25 (6.35)	1.13 (28.58)	1-1/4	SLORD-119	1.22
1-1/4-12	12	0.25 (6.35)	1.38 (34.93)	1-1/2	SLORD-123	1.47

EXAMPLE:

• **CLHA - 875E10**

HEX ADAPTER, 7/8-14 THD., #5 RW TAPER, ELECTRODE ADAPTER, LENGTH = 1.25 (31.75).

EXAMPLE EXPLANATION CODING

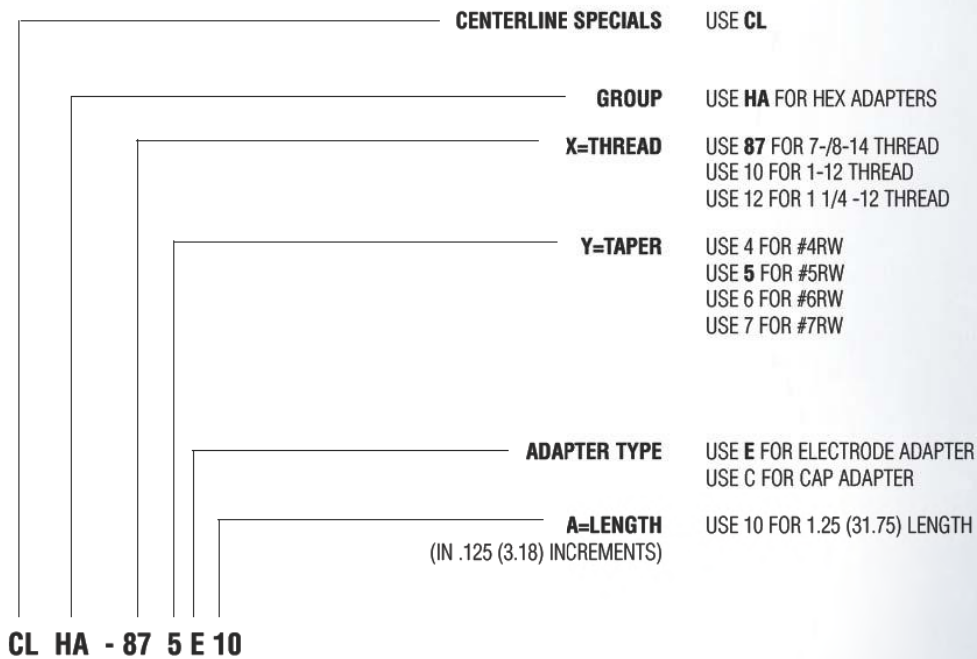



STANDARD ADAPTERS

Cap and Electrode Hex Adapters
Pipe Thread

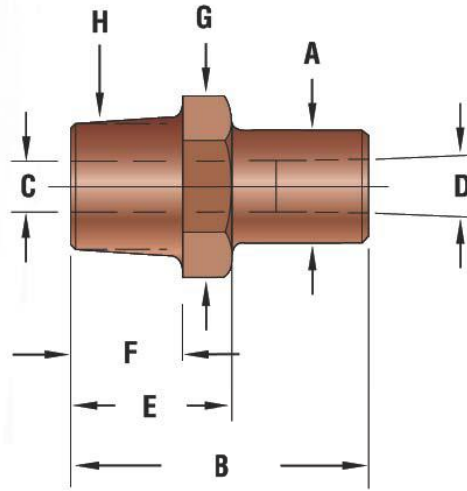

- Dimensions Shown Are: inches (mm).
- See Pg. 2-2 For Caps.

FIGURE 3-10 (Material RWMA Class 2 & 3)

ELECTRODE ADAPTER CHART

ELECTRODE CODE	4	5	4	5	5	6	7
A- DIAMETER	0.88 (22.35)	0.94 (23.88)	0.88 (22.35)	0.94 (23.88)	0.94 (23.88)	1.09 (27.69)	1.24 (31.50)
B- LENGTH	AS CODED						
LENGTH (Minimum)	0.88 (22.35)	0.88 (22.35)	1.00 (25.40)	1.00 (25.40)	1.12 (28.45)	1.12 (28.45)	1.38 (35.05)
C- HOLE DIAMETER	0.42 (10.67)	0.44 (11.18)	0.42 (10.67)	0.44 (11.18)	0.44 (11.18)	0.50 (12.70)	0.56 (14.22)
D- TAPER DIAMETER	0.463 (11.76)	0.625 (15.88)	0.463 (15.88)	0.625 (15.88)	0.625 (15.88)	0.750 (19.05)	0.875 (22.22)
E- HEX LENGTH	0.88 (22.35)	0.88 (22.35)	1.00 (25.40)	1.00 (25.40)	1.38 (35.05)	1.38 (35.05)	1.38 (35.05)
F- THREAD LENGTH	0.62 (15.75)	0.62 (15.75)	0.75 (19.05)	0.75 (19.05)	0.88 (22.35)	0.88 (22.35)	0.88 (22.35)
G- HEX	1.00 (25.40)	1.00 (25.40)	1.00 (25.40)	1.00 (25.40)	1.25 (31.75)	1.25 (31.75)	1.25 (31.75)
H- THREAD (N.P.T.)	1/2	1/2	5/8	5/8	3/4	3/4	3/4

CAP ADAPTER CHART

ELECTRODE CODE	4	5	4	5	5	6	6-1	7
A- DIAMETER	0.50 (12.70)	0.62 (15.75)	0.50 (12.70)	0.62 (15.75)	0.62 (15.75)	0.75 (19.05)	0.75 (19.05)	0.88 (22.35)
B- LENGTH	AS CODED							
LENGTH (Minimum)	0.88 (22.35)	0.88 (22.35)	1.00 (25.40)	1.00 (25.40)	1.12 (28.45)	1.12 (28.45)	1.12 (28.45)	1.12 (28.45)
C- HOLE DIAMETER	0.28 (7.11)	0.38 (9.65)	0.28 (7.11)	0.38 (9.65)	0.38 (9.65)	0.44 (11.18)	0.44 (11.18)	0.56 (14.22)
D- TAPER DIAMETER	0.313 (7.95)	0.414 (10.52)	0.313 (7.95)	0.414 (10.52)	0.414 (10.52)	0.500 (12.70)	0.562 (14.27)	0.700 (17.78)
E- HEX LENGTH	0.88 (22.35)	0.88 (22.35)	1.00 (25.40)	1.00 (25.40)	1.38 (35.05)	1.38 (35.05)	1.38 (35.05)	1.38 (35.05)
F- THREAD LENGTH	0.62 (15.75)	0.62 (15.75)	0.75 (19.05)	0.75 (19.05)	0.88 (22.35)	0.88 (22.35)	0.88 (22.35)	0.88 (22.35)
G- HEX	1.00 (25.40)	1.00 (25.40)	1.00 (25.40)	1.00 (25.40)	1.25 (31.75)	1.25 (31.75)	1.25 (31.75)	1.25 (31.75)
H- THREAD (N.P.T.)	1/2	1/2	5/8	5/8	3/4	3/4	3/4	3/4

• TO ORDER YOUR SPECIALS USE CODING CHART - SEE PG. 3-14

STANDARD ADAPTERS

Cap and Electrode Hex Adapters
Pipe Thread

EXAMPLE EXPLANATION CODING

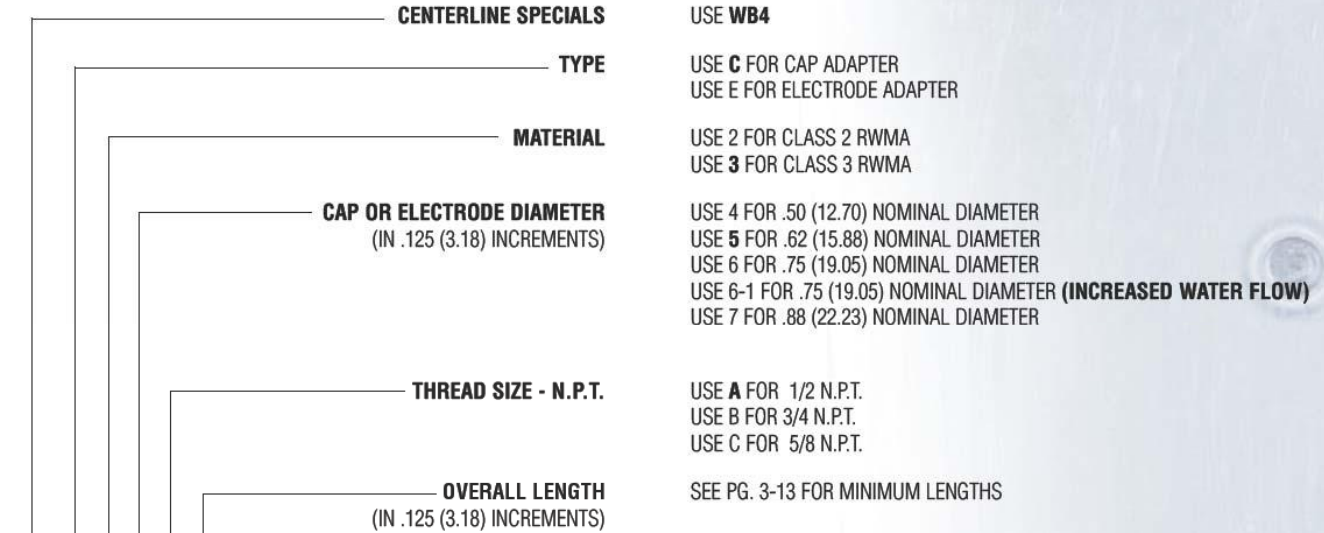

WB4 C-3 5 A 10

**SAMPLE
TYPICAL THREADED ADAPTER CODING**

- ADAPTER WILL BE 1.25 (31.75) LONG
- ADAPTER WILL HAVE 1/2 N.P.T. (THREAD SIZE)
- ADAPTER WILL BE USED WITH .62 (15.88) DIAMETER CAP
- ADAPTER WILL BE MADE OF CLASS 3 RWMA
- ADAPTER WILL BE MADE FOR CAP TYPE ELECTRODE

EXAMPLE:

• **WB4C-35A10**

• Dimensions Shown Are: inches (mm)