

HOLDERS

Standard Non-Ejector Holders

- RW-1015 Brass Connection Fits 3/8 Hose

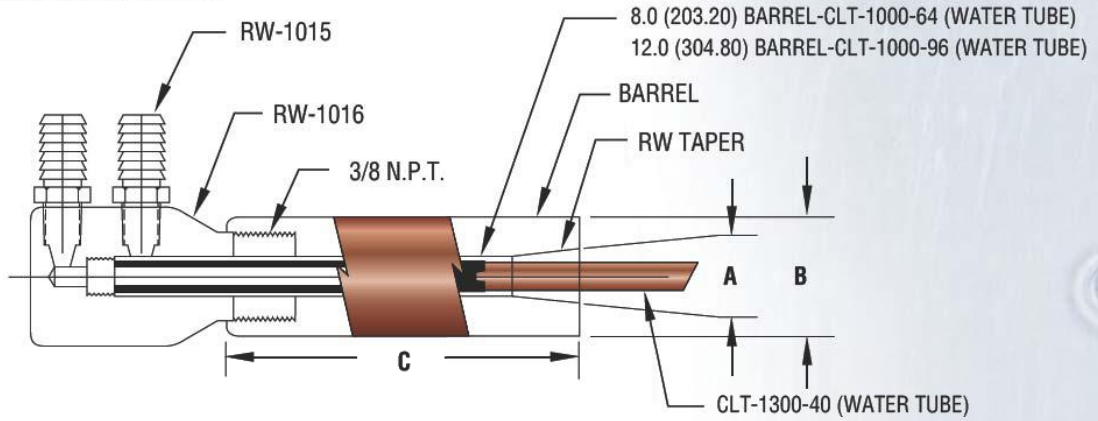


FIGURE 5-1 (Material RWMA Class 2)

HOLDER #	A10804	A20804	A30804	A30805	A40805	A50805	A31204	A31205	A41205
RW Taper	4	4	4	5	5	5	4	5	5
A – Diameter	.463 (11.76)	.463 (11.76)	.463 (11.76)	.625 (15.88)	.625 (15.88)	.625 (15.88)	.463 (11.76)	.625 (15.88)	.625 (15.88)
B – Diameter	.75 (19.05)	.88 (22.23)	1.00 (25.40)	1.00 (25.40)	1.25 (31.75)	1.50 (38.10)	1.00 (25.40)	1.00 (25.40)	1.25 (31.75)
C – Length	8.0 (203.20)	8.0 (203.20)	8.0 (203.20)	8.0 (203.20)	8.0 (203.20)	8.0 (203.20)	12.0 (304.80)	12.0 (304.80)	12.0 (304.80)
BARREL	RW-1121-2	RW-1121-3	RW-1121-4	RW-1121-6	RW-1121-7	RW-1121-8	RW-1121-9	RW-1121-10	RW-1121-11

Close-Coupled Holders

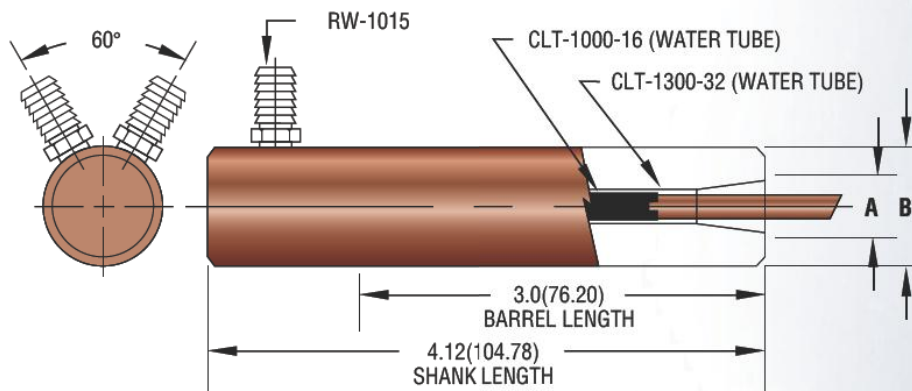


FIGURE 5-2 (Material RWMA Class 2)

HOLDER #	1-20304	1-30304	1-40304	1-20305	1-30305	1-40305
A – RW Taper	4	4	4	5	5	5
B – Diameter	.88 (22.23)	1.00 (25.40)	1.25 (31.75)	.88 (22.23)	1.00 (25.40)	1.25 (31.75)

- FOR USE WHERE WELDING SPACE IS LIMITED. STANDARD BODY LENGTH IS 3.0 (76.20).

• Dimensions Shown Are: inches (mm).



HOLDERS

Offset Non-Ejector Electrode Holders

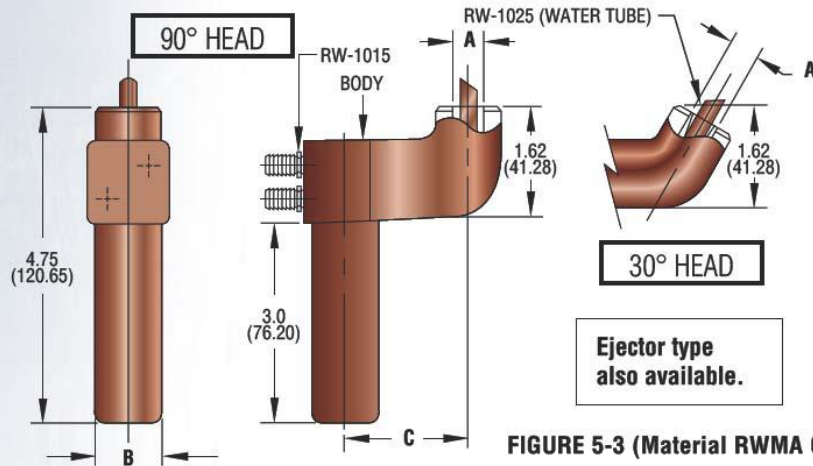


FIGURE 5-3 (Material RWMA Class 3)

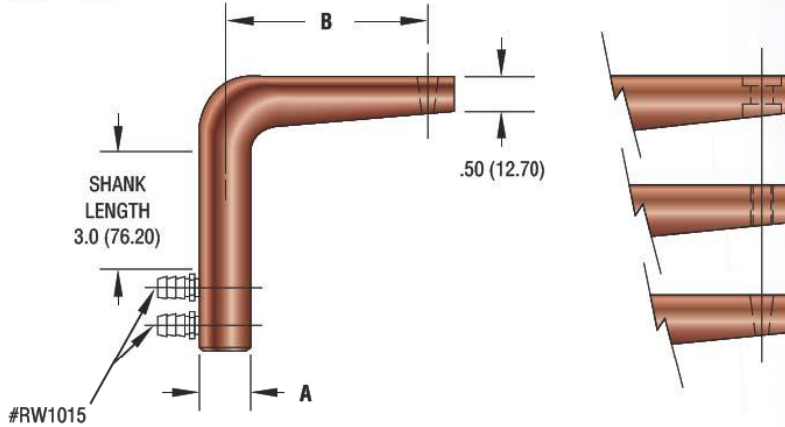
• Dimensions Shown Are: inches (mm).

OFFSET HOLDERS - Ordering Chart				
90° COMPLETE HOLDER NO.	B30304	B40304	B30305	B40305
RW Electrode Taper	4	4	5	5
A – Diameter	.463 (11.76)	.463 (11.76)	.619 (15.72)	.619 (15.72)
B – Diameter	1.00 (25.40)	1.25 (31.75)	1.00 (25.40)	1.25 (31.75)
C – Offset	2.00 (50.80)	2.00 (50.80)	2.00 (50.80)	2.00 (50.80)
Body	RW-1122-2	RW-1122-3	RW-1122-5	RW-1122-6
90° COMPLETE HOLDER NO.	G30304	G40304	G30305	G40305
RW Electrode Taper	4	4	5	5
A – Diameter	.463 (11.76)	.463 (11.76)	.619 (15.72)	.619 (15.72)
B – Diameter	1.00 (25.40)	1.25 (31.75)	1.00 (25.40)	1.25 (31.75)
C – Offset	3.00 (76.20)	3.00 (76.20)	3.00 (76.20)	3.00 (76.20)
Body	RW-1126-2	RW-1126-3	RW-1126-5	RW-1126-6
90° COMPLETE HOLDER NO.	C30304	C40304	C30305	C40305
RW Electrode Taper	4	4	5	5
A – Diameter	.463 (11.76)	.463 (11.76)	.619 (15.72)	.619 (15.72)
B – Diameter	1.00 (25.40)	1.25 (31.75)	1.00 (25.40)	1.25 (31.75)
C – Offset	4.00 (101.60)	4.00 (101.60)	4.00 (101.60)	4.00 (101.60)
Body	RW-1123-2	RW-1123-3	RW-1123-5	RW-1123-6
30° COMPLETE HOLDER NO.	D30304	D40304	D30305	D40305
RW Electrode Taper	4	4	5	5
A – Diameter	.463 (11.76)	.463 (11.76)	.619 (15.72)	.619 (15.72)
B – Diameter	1.00 (25.40)	1.25 (31.75)	1.00 (25.40)	1.25 (31.75)
C – Offset	2.00 (50.80)	2.00 (50.80)	2.00 (50.80)	2.00 (50.80)
Body	RW-1124-2	RW-1124-3	RW-1124-5	RW-1124-6
30° COMPLETE HOLDER NO.	E30304	E40304	E30305	E40305
RW Electrode Taper	4	4	5	5
A – Diameter	.463 (11.76)	.463 (11.76)	.619 (15.72)	.619 (15.72)
B – Diameter	1.00 (25.40)	1.25 (31.75)	1.00 (25.40)	1.25 (31.75)
C – Offset	3.00 (76.20)	3.00 (76.20)	3.00 (76.20)	3.00 (76.20)
Body	RW-1127-2	RW-1127-3	RW-1127-5	RW-1127-6
30° COMPLETE HOLDER NO.	F30304	F40304	F30305	F40305
RW Electrode Taper	4	4	5	5
A – Diameter	.463 (11.76)	.463 (11.76)	.619 (15.72)	.619 (15.72)
B – Diameter	1.00 (25.40)	1.25 (31.75)	1.00 (25.40)	1.25 (31.75)
C – Offset	4.00 (101.60)	4.00 (101.60)	4.00 (101.60)	4.00 (101.60)
Body	RW-1125-2	RW-1125-3	RW-1125-5	RW-1125-6

HOLDERS

Paddle Type Holders - Type 1, 2 & 3

ITEM NO. - CLP -



SAMPLE TIPS:

- TYPE-1 – XC-2998**
• See Pg. 2-3 For Caps.
- TYPE-2 – CL-78-50C**
• See Pg. 2-4 For Caps.
- TYPE-3 – CLPC-2998**
• See Pg. 2-3 For Caps.

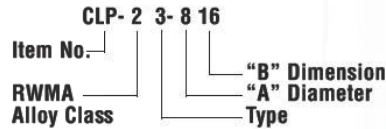
FIGURE 5-4 (Material RWMA Class 2 & 3)

• FINAL FIGURE USED IN ORDERING –

- Indicate Desired Shank Diameter "A" - In .125 (3.18) Increments
- Indicate Desired Offset Dimension "B" - In .250 (6.35) Increments
- For Holders & Tips Specify RWMA Class 2 Or 3 Requirements

EXAMPLE:

HOLDER, RWMA CLASS 2, TYPE - 3, "A" = 1.00 (25.40) DIAMETER, "B" = 4.00 (101.60) OFFSET.



Platen Mount - Holders

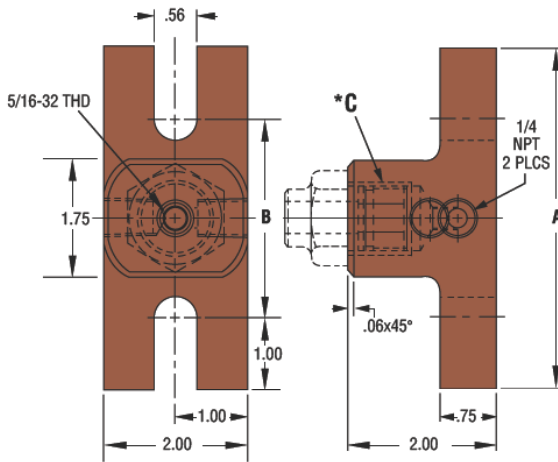


FIGURE 5-5 (Material RWMA Class 2)

See pages 3-12 & 3-13 for Adapters.

See pages 8-1 & 8-2 for Water Tubes.

DIM.	CL-1-PM-"X"	CL-2-PM-"X"
A	4.75 (120.65)	7.00 (177.80)
B	2.75 (69.85)	4.31 (109.47)

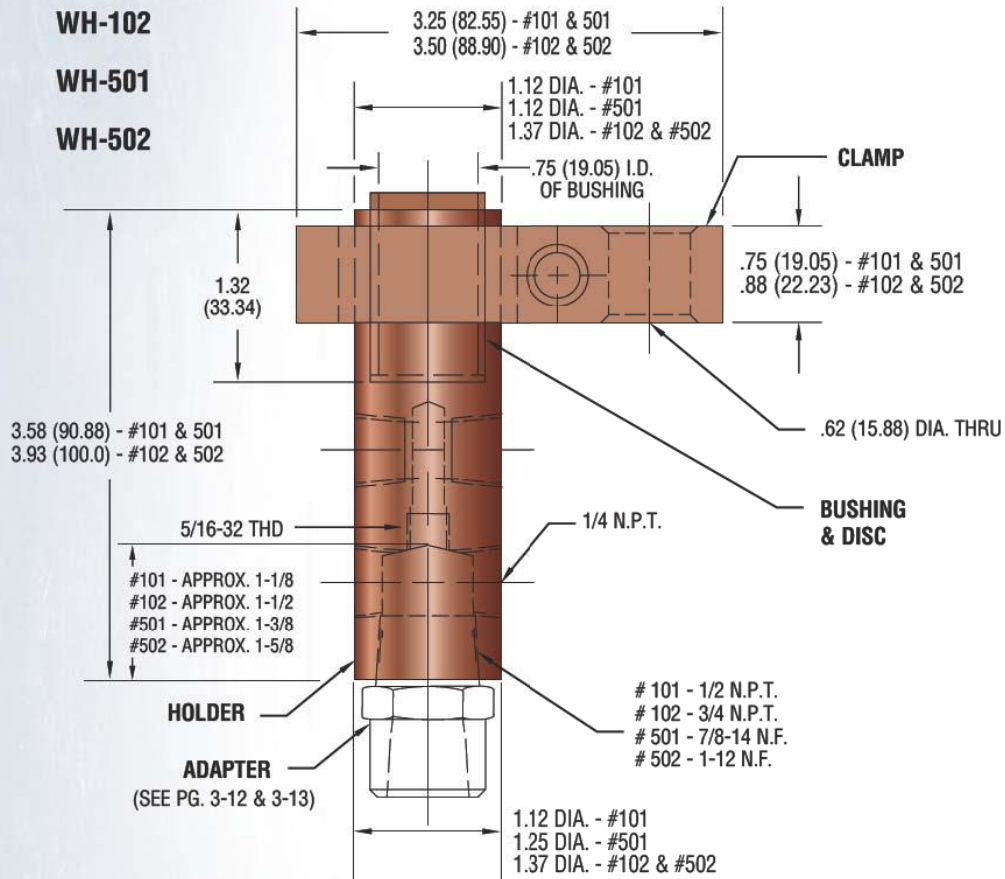
C*	X
For these thread/taper types	Replace "X" with
1/2 Pipe Thread	50P
5/8 Pipe Thread	62P
3/4 Pipe Thread	75P
7/8-14 Straight Thread	87S
1-12 Straight Thread	10S
4RW Taper	4E
5RW Taper	5E
6RW Taper	6E
7RW Taper	7E
*Other threads/tapers available upon request	



HOLDERS

Cylinder Mounted Holders

- ITEM NO. WH-101
- WH-102
- WH-501
- WH-502



• Dimensions Shown Are: inches (mm).

FIGURE 5-6 (Material - Copper)

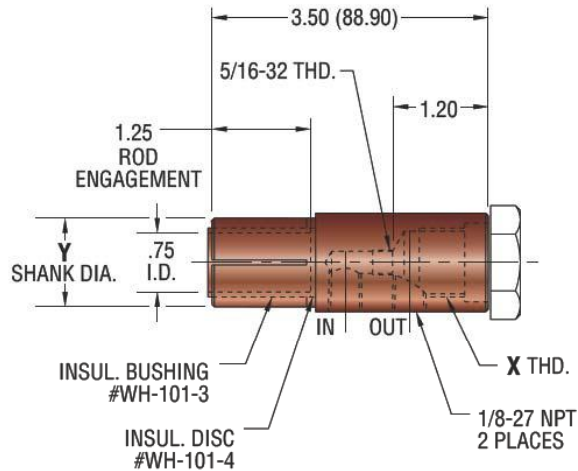
101, 102, 501 & 502 SERIES HOLDERS

DETAILS	1/2 N.P.T.	3/4 N.P.T.	7/8-14 N.F.	1-12 N.F.
ASSEMBLY NO.*	WH-1010C	WH-1020C	WH-5010C	WH-5020C
BARREL	WH-101-1	WH-102-1	WH-501-1	WH-502-1
CLAMP NO.	WH-101-2	WH-102-2	WH-101-2	WH-102-2
BUSHING NO.	WH-101-3	WH-101-3	WH-101-3	WH-101-3
DISC NO.	WH-101-4	WH-101-4	WH-101-4	WH-101-4

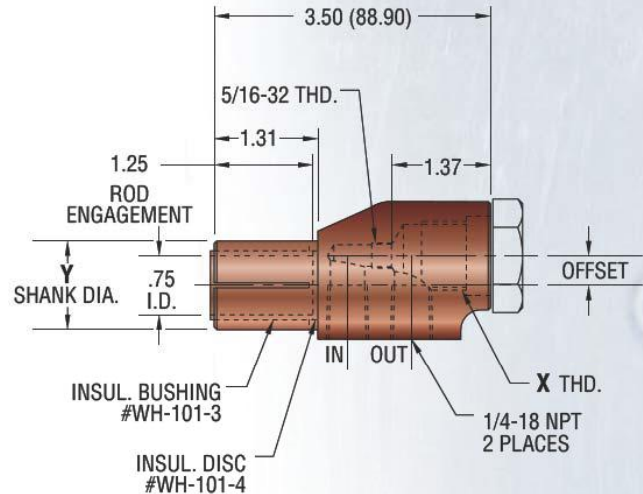
*A complete assembly consists of a barrel, clamp, bushing and disc.

HOLDERS

Cylinder Mounted Holders

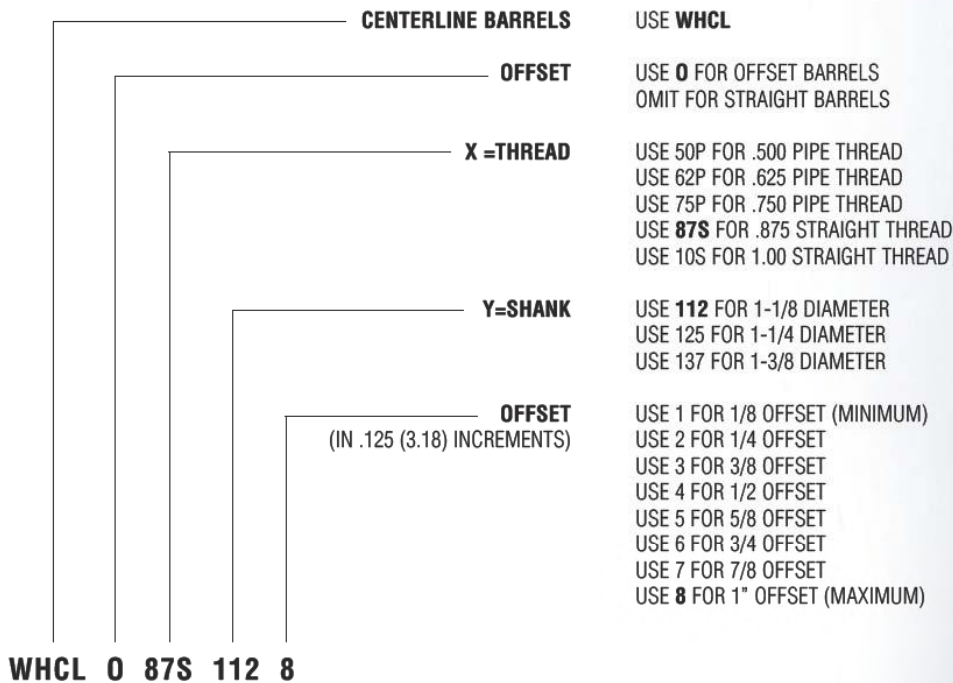


**FIGURE 5-7 (Material RWMA Class 2)
Straight Barrel (WHCL Series)**



**FIGURE 5-8 (Material RWMA Class 3)
Offset Barrel (WHCLO Series)**

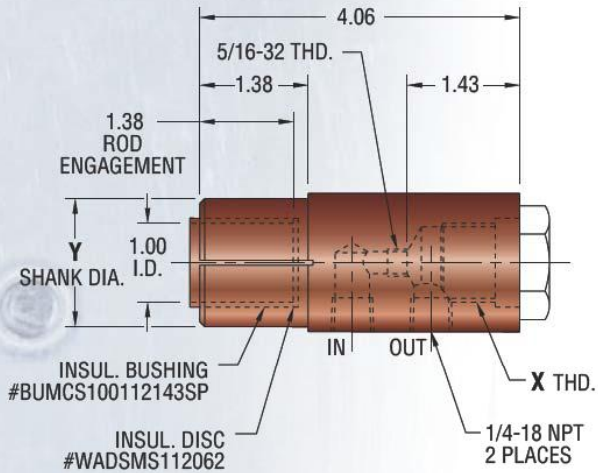
EXAMPLE EXPLANATION CODING



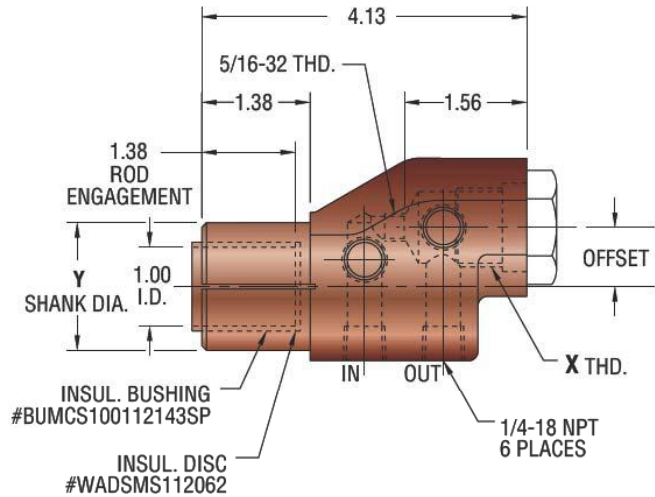


HOLDERS

Heavy Duty Cylinder Mounted Holders

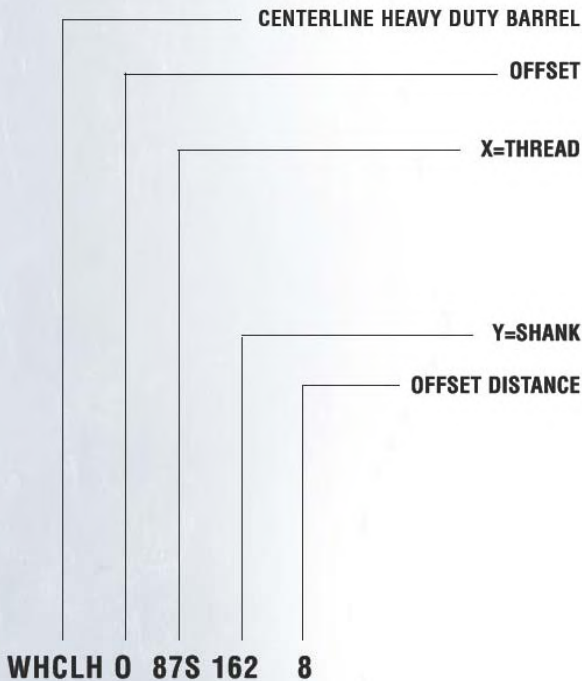


**FIGURE 5-9 (Material RWMA Class 2)
HEAVY DUTY STRAIGHT BARREL
(WHCLH Series)**



**FIGURE 5-10 (Material RWMA Class 3)
HEAVY DUTY OFFSET BARREL
(WHCLHO Series)**

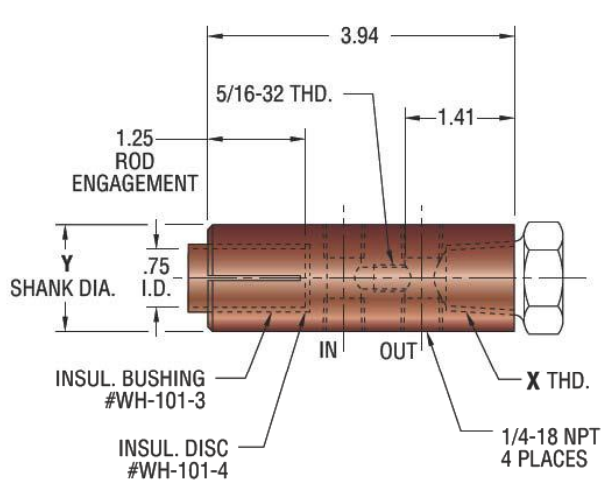
EXAMPLE EXPLANATION CODING



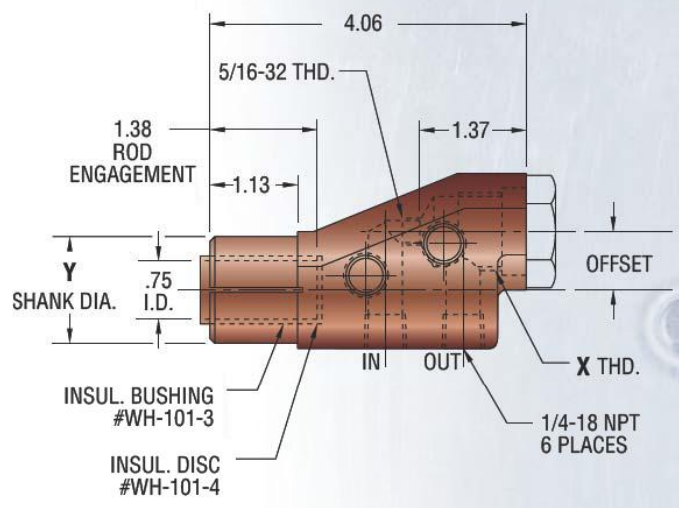
- USE **WHCLH**
- USE **0** FOR OFFSET BARRELS
OMIT FOR STRAIGHT BARRELS
- USE 50P FOR .500 PIPE THREAD
USE 62P FOR .625 PIPE THREAD
USE 75P FOR .750 PIPE THREAD
USE **87S** FOR .875 STRAIGHT THREAD
USE 10S FOR 1.00 STRAIGHT THREAD
USE 12S FOR 1.25 STRAIGHT THREAD
- USE **162** FOR 1-5/8 DIAMETER
- USE 1 FOR 1/8 OFFSET (MINIMUM)
USE 2 FOR 1/4 OFFSET
USE 3 FOR 3/8 OFFSET
USE 4 FOR 1/2 OFFSET
USE 5 FOR 5/8 OFFSET
USE 6 FOR 3/4 OFFSET
USE 7 FOR 7/8 OFFSET
USE **8** FOR 1" OFFSET (MAXIMUM)

HOLDERS

Light Duty Cylinder Mounted Holders

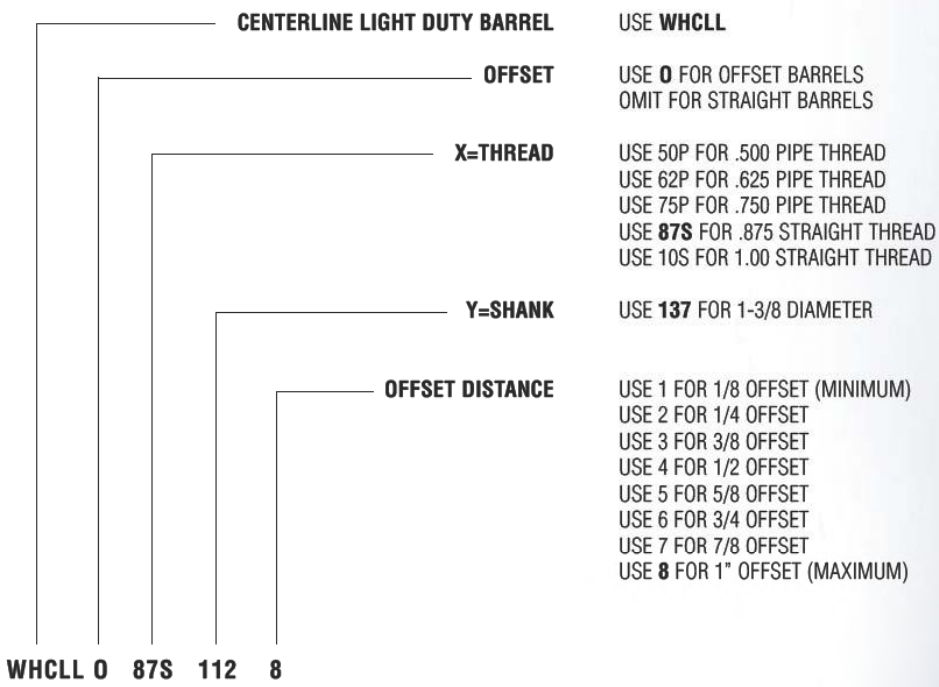


**FIGURE 5-11 (Material RWMA Class 2)
LIGHT DUTY STRAIGHT BARREL
(WHCLL Series)**



**FIGURE 5-12 (Material RWMA Class 3)
LIGHT DUTY OFFSET BARREL
(WHCLLO Series)**

EXAMPLE EXPLANATION CODING





HOLDERS

Light Duty Shunt/Cable Clamps

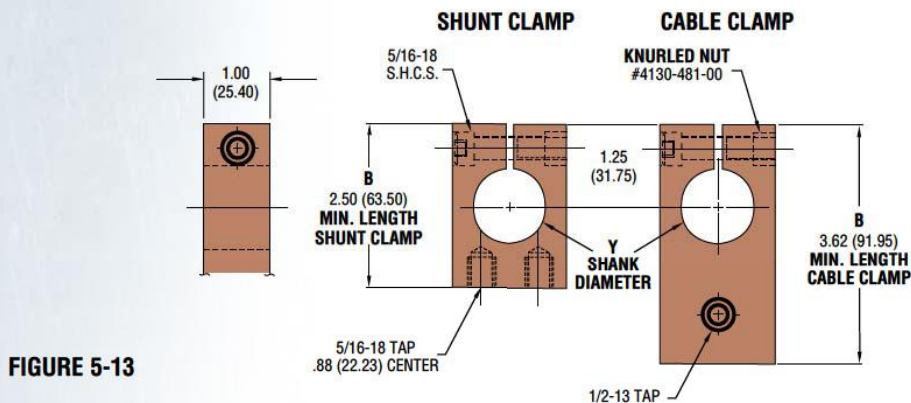


FIGURE 5-13

EXAMPLE EXPLANATION CODING

CENTERLINE CABLE/SHUNT CLAMPS		USE WHCLSA FOR SHUNT CLAMPS USE WHCLCA FOR CABLE CLAMPS
Y = SHANK DIAMETER		USE 112 FOR 1.125 DIAMETER USE 125 FOR 1.250 DIAMETER USE 137 FOR 1.375 DIAMETER
B = LENGTH		USE 0250 FOR 2.50 LENGTH (MIN. FOR WHCLSA) USE 0362 FOR 3.62 LENGTH (MIN. FOR WHCLCA) etc.

WHCLSA 112 0250

Heavy Duty Shunt/Cable Clamps

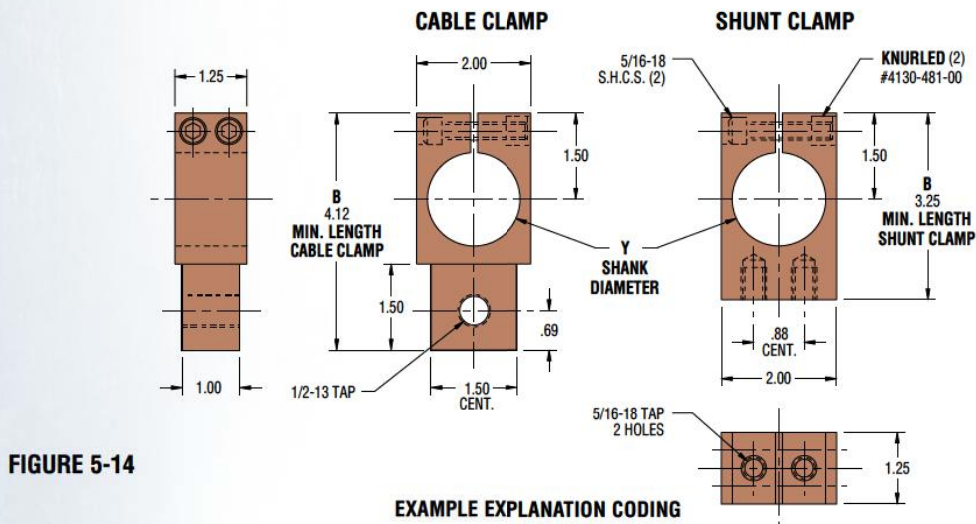


FIGURE 5-14

EXAMPLE EXPLANATION CODING

CENTERLINE HEAVY DUTY CABLE/SHUNT CLAMPS		USE WHCLHSA FOR SHUNT CLAMPS USE WHCLHCA FOR CABLE CLAMPS
Y = SHANK DIAMETER		USE 162 FOR 1.625 DIAMETER
B = LENGTH		USE 0325 FOR 3.25 LENGTH (MIN. FOR WHCLHSA) USE 0412 FOR 4.12 LENGTH (MIN. FOR WHCLHCA) etc.

WHCLHCA 162 0412