



ELECTRODE CAPS

Replaceable Female Spot Welding Caps

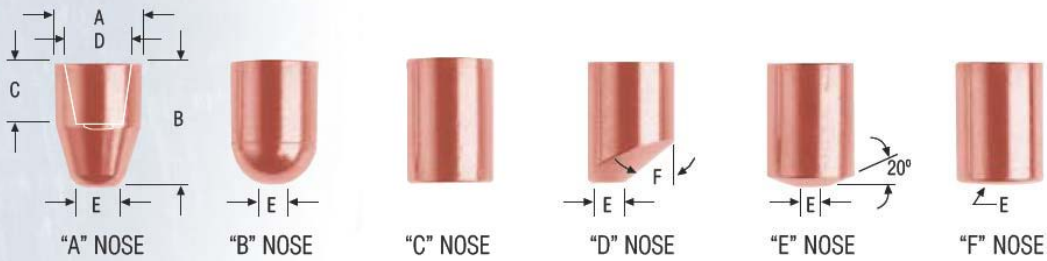

FIGURE 2-1 (Material RWMA Class 2, 3, Zirconium & Dispersion Strengthened Copper)

• Dimensions Shown Are: inches (mm). • See pages 12-1 & 12-2 for reference data.

Item No.		DIMENSIONS					
CLASS 2		A Major Diameter	B Overall Length Standard/Short	C Taper Length	D Taper Diameter	E Welding Face Diameter	F Offset Angle
Standard	Short Caps					Standard/Short	Standard/Short
CLFA-24	CLFA-24S	.500 (12.70)	.84 (21.34) / .59 (14.99)	.32 (8.13)	.394 (10.01)	.19 (4.76)/.25(6.35)	
CLFB-24	CLFB-24S	.500 (12.70)	.84 (21.34) / .59 (14.99)	.32 (8.13)	.394 (10.01)	.12(3.17)	
CLFC-24	CLFC-24S	.500 (12.70)	.84 (21.34) / .59 (14.99)	.32 (8.13)	.394 (10.01)	-----	
CLFD-24	CLFD-24S	.500 (12.70)	.84 (21.34) / .59 (14.99)	.32 (8.13)	.394 (10.01)	.19 (4.76)	40° / 35°
CLFE-24	CLFE-24S	.500 (12.70)	.84 (21.34) / .59 (14.99)	.32 (8.13)	.394 (10.01)	.19 (4.76)	
CLFF-24	CLFF-24S	.500 (12.70)	.84 (21.34) / .59 (14.99)	.32 (8.13)	.394 (10.01)	2.00 (50.80) sphere. rad.	
CLFA-25	CLFA-25S	.625 (15.88)	.88 (22.23) / .63 (16.00)	.38 (9.53)	.495 (12.57)	.25 (6.35)	
CLFB-25	CLFB-25S	.625 (15.88)	.88 (22.23) / .63 (16.00)	.38 (9.53)	.495 (12.57)	.19 (4.76)	
CLFC-25	CLFC-25S	.625 (15.88)	.88 (22.23) / .63 (16.00)	.38 (9.53)	.495 (12.57)	-----	
CLFD-25	CLFD-25S	.625 (15.88)	.88 (22.23) / .63 (16.00)	.38 (9.53)	.495 (12.57)	.25 (6.35)	40° / 30°
CLFE-25	CLFE-25S	.625 (15.88)	.88 (22.23) / .63 (16.00)	.38 (9.53)	.495 (12.57)	.25 (6.35)	
CLFF-25	CLFF-25S	.625 (15.88)	.88 (22.23) / .63 (16.00)	.38 (9.53)	.495 (12.57)	2.00 (50.80) sphere. rad.	
CLFA-26	CLFA-26S	.750 (19.05)	1 (25.40) / .75 (19.05)	.47 (11.94)	.625 (15.88)	.31 (7.94)	
CLFB-26	CLFB-26S	.750 (19.05)	1 (25.40) / .75 (19.05)	.47 (11.94)	.625 (15.88)	.19 (4.76)	
CLFC-26	CLFC-26S	.750 (19.05)	1 (25.40) / .75 (19.05)	.47 (11.94)	.625 (15.88)	-----	
CLFD-26	CLFD-26S	.750 (19.05)	1 (25.40) / .75 (19.05)	.47 (11.94)	.625 (15.88)	.31 (7.94)	45° / 30°
CLFE-26	CLFE-26S	.750 (19.05)	1 (25.40) / .75 (19.05)	.47 (11.94)	.625 (15.88)	.31 (7.94)	
CLFF-26	CLFF-26S	.750 (19.05)	1 (25.40) / .75 (19.05)	.47 (11.94)	.625 (15.88)	2.00 (50.80) sphere. rad.	

• ADDITIONAL LENGTHS ARE AVAILABLE UPON REQUEST.

FOR ALL OTHER ITEMS:

- Check Key To Item Numbers For Availability
- Use Example For Ordering Available Items

KEY TO ITEM NUMBERS

- CLF - Cap Designation
- A,B,C,D,E,F - Nose Designation
- 2,3 - RWMA Alloy Class
- Z - Zirconium
- G - Dispersion Strengthened Copper
- 4 THRU 6 - Major Diameter In .125 (3.18) Increments
- S - Short overall length

EXAMPLE:

FEMALE CAP, A NOSE, ZIRCONIUM, A = .750 (19.05) DIAMETER

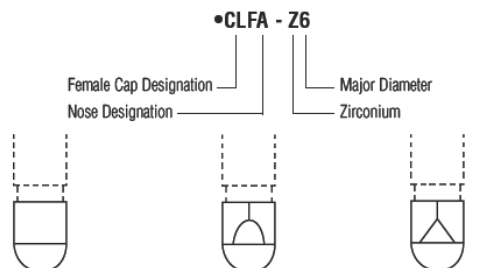

Glidcop® is a registered trademark of SCM Metal Products Inc.

ELECTRODE CAPS

Replaceable Male Spot Welding Caps



FIGURE 2-2 (Material RWMA Class 2, 3, Zirconium & Dispersion Strengthened Copper)

• Dimensions Shown Are: inches (mm). • See pages 12-1 & 12-2 for reference data.

Item No.	DIMENSIONS								
	A	B	C	D	E	F	G	H	
CLASS 2 Standard	Major Diameter	Overall Length	Taper Length	Taper Diameter	Welding Face Diameter	Water Hole Diameter	Water Hole Depth	Offset Angle	
WA-24	.482 (12.24)	1.12 (28.45)	.38 (9.53)	.375 (9.53)	.19 (4.76)	.28 (7.14)	.62 (15.88)		
WB-24	.482 (12.24)	1.12 (28.45)	.38 (9.53)	.375 (9.53)	.19 (4.76)	.28 (7.14)	.62 (15.88)		
WC-24	.482 (12.24)	1.12 (28.45)	.38 (9.53)	.375 (9.53)	-----	.28 (7.14)	.62 (15.88)		
WD-24	.482 (12.24)	1.12 (28.45)	.38 (9.53)	.375 (9.53)	.19 (4.76)	.28 (7.14)	.62 (15.88)	40°	
WE-24	.482 (12.24)	1.12 (28.45)	.38 (9.53)	.375 (9.53)	.19 (4.76)	.28 (7.14)	.62 (15.88)		
WF-24-2	.482 (12.24)	1.12 (28.45)	.38 (9.53)	.375 (9.53)	2.00 (50.80) sphere. rad.	.28 (7.14)	.62 (15.88)		
WA-25	.625 (15.88)	1.25 (41.15)	.50 (12.70)	.415 (10.54)	.25 (6.35)	.31 (7.94)	.875 (22.23)		
WB-25	.625 (15.88)	1.25 (41.15)	.50 (12.70)	.415 (10.54)	.19 (4.76)	.31 (7.94)	.875 (22.23)		
WC-25	.625 (15.88)	1.25 (41.15)	.50 (12.70)	.415 (10.54)	-----	.31 (7.94)	.875 (22.23)		
WD-25	.625 (15.88)	1.25 (41.15)	.50 (12.70)	.415 (10.54)	.25 (6.35)	.31 (7.94)	.875 (22.23)	40°	
WE-25	.625 (15.88)	1.25 (41.15)	.50 (12.70)	.415 (10.54)	.25 (6.35)	.31 (7.94)	.875 (22.23)		
WF-25-2	.625 (15.88)	1.25 (41.15)	.50 (12.70)	.415 (10.54)	2.00 (50.80) sphere. rad.	.31 (7.94)	.875 (22.23)		
WA-26	.750 (19.05)	1.62 (41.15)	.63 (15.88)	.500 (12.70)	.31 (7.94)	.38 (9.53)	1 (25.40)		
WB-26	.750 (19.05)	1.62 (41.15)	.63 (15.88)	.500 (12.70)	.19 (4.76)	.38 (9.53)	1 (25.40)		
WC-26	.750 (19.05)	1.62 (41.15)	.63 (15.88)	.500 (12.70)	-----	.38 (9.53)	1 (25.40)		
WD-26	.750 (19.05)	1.62 (41.15)	.63 (15.88)	.500 (12.70)	.31 (7.94)	.38 (9.53)	1 (25.40)	45°	
WE-26	.750 (19.05)	1.62 (41.15)	.63 (15.88)	.500 (12.70)	.31 (7.94)	.38 (9.53)	1 (25.40)		
WF-26-4	.750 (19.05)	1.62 (41.15)	.63 (15.88)	.500 (12.70)	4.00 (101.60) sphere. rad.	.38 (9.53)	1 (25.40)		
WA-27	.875 (22.23)	1.62 (41.15)	.63 (15.88)	.613 (15.57)	.31 (7.94)	.50 (12.70)	1 (25.40)		
WB-27	.875 (22.23)	1.62 (41.15)	.63 (15.88)	.613 (15.57)	.25 (6.35)	.50 (12.70)	1 (25.40)		
WC-27	.875 (22.23)	1.62 (41.15)	.63 (15.88)	.613 (15.57)	-----	.50 (12.70)	1 (25.40)		
WD-27	.875 (22.23)	1.62 (41.15)	.63 (15.88)	.613 (15.57)	.31 (7.94)	.50 (12.70)	1 (25.40)	45°	
WE-27	.875 (22.23)	1.62 (41.15)	.63 (15.88)	.613 (15.57)	.31 (7.94)	.50 (12.70)	1 (25.40)		
WF-27-6	.875 (22.23)	1.62 (41.15)	.63 (15.88)	.613 (15.57)	6.00 (152.40) sphere. rad.	.50 (12.70)	1 (25.40)		

• ADDITIONAL LENGTHS ARE AVAILABLE UPON REQUEST.

FOR ALL OTHER ITEMS:

- Check Key To Item Numbers For Availability
- Use Example For Ordering Available Items

KEY TO ITEM NUMBERS

- W - Cap Designation
- A,B,C,D,E,F - Nose Designation
- 2,3 - RWMA Alloy Class
- Z - Zirconium
- G - Dispersion Strengthened Copper
- 4 THRU 7 - Major Diameter In .125 (3.18) Increments

EXAMPLE:
MALE CAP, A NOSE, CLASS 3, A = .875 (22.23) DIAMETER

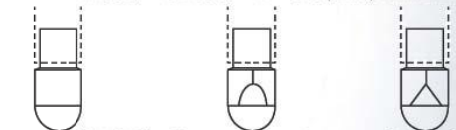

Class 2 (CuCrZr) Copper-Zirconium Glidcop®
Glidcop® is a registered trademark of SCM Metal Products Inc.





ELECTRODE CAPS

Replaceable Button Caps

For Paddle Holder Type 1 - See Page 5-3

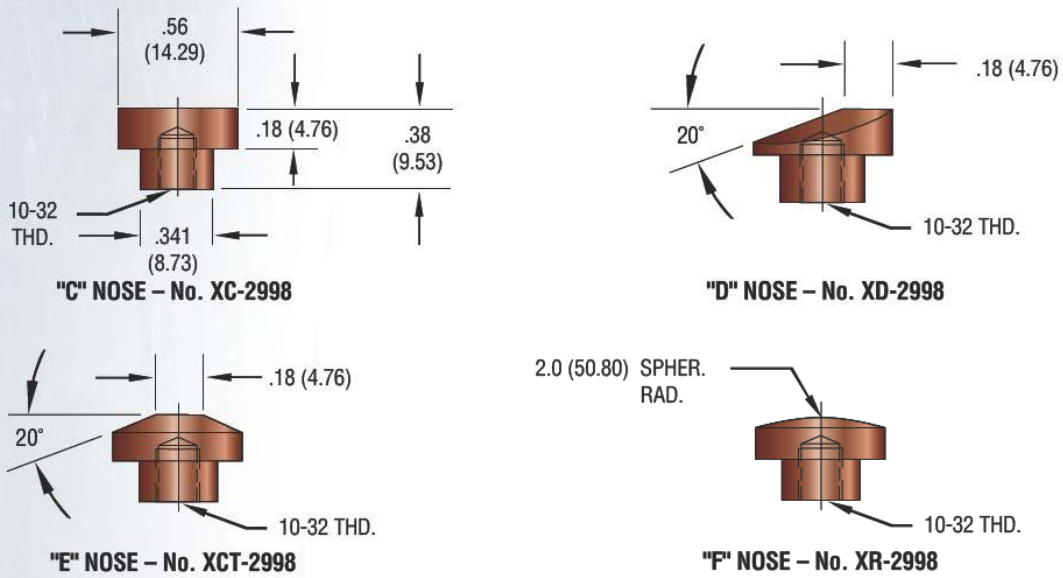

FIGURE 2-3 (Material RWMA Class 2)

For Paddle Holder Type 3 - See Page 5-3

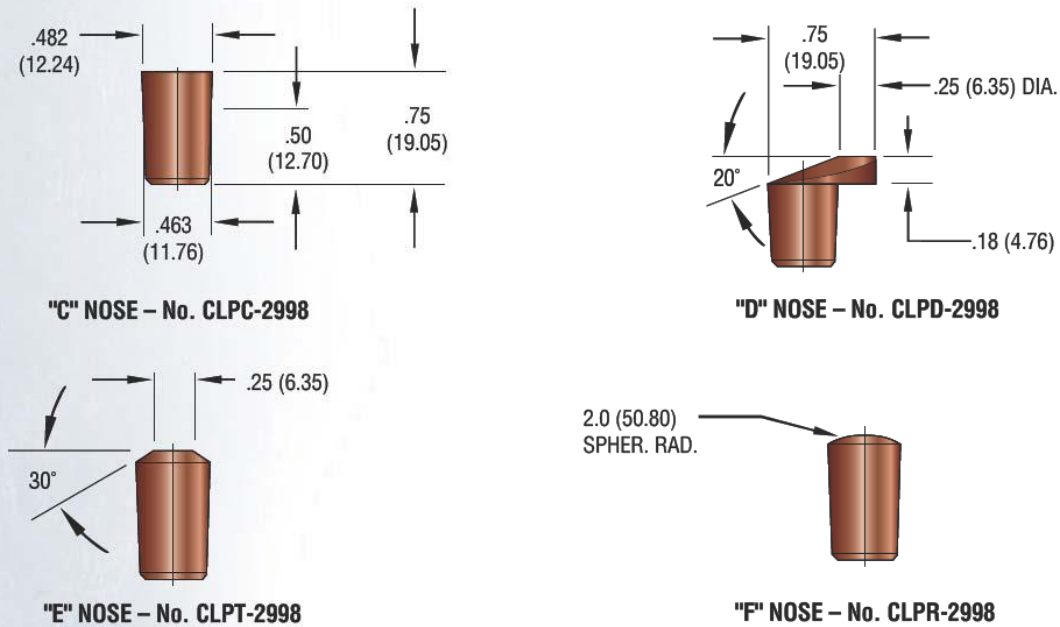

FIGURE 2-4 (Material RWMA Class 2)

• Dimensions Shown Are: inches (mm).

ELECTRODE CAPS

Button Caps

For Paddle Holder Type 2 – See Page 5-3

EXAMPLE – CLR2-78-AY

CLR2-78 = RWMA Class 2
CLR3-78 = RWMA Class 3
CLRZ-78 = Zirconium

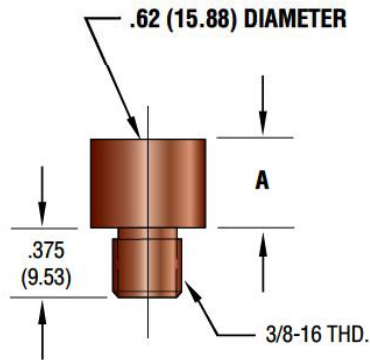

Item No.	"A" = Height
CLR2-78-31C	.312 (7.92)
CLR2-78-37C	.375 (9.53)
CLR2-78-43C	.437 (11.10)
CLR2-78-50C	.500 (12.70)
CLR2-78-62C	.625 (15.88)
CLR2-78-75C	.750 (19.05)
ETC.	See Example

FIGURE 2-5 (Material RWMA Class 2, 3 & Zirconium)

EXAMPLE – CLH3-78-AY

CLH2-78 = RWMA Class 2
CLH3-78 = RWMA Class 3

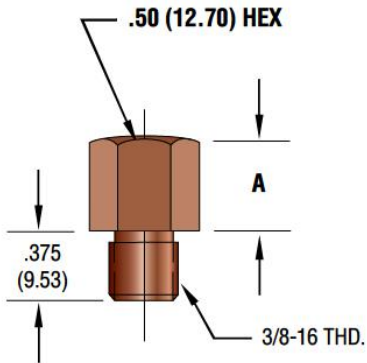

"Y" = NOSE DESIGNATION

- * A = Pointed
- * B = Dome
- C = Flat (Shown)
- * E = Truncated (20°)
- F = .62 (15.88) Radius

* 0.25(6.35) Weld Face Diameter

• Dimensions Shown Are: inches (mm).

FIGURE 2-6 (Material RWMA Class 2 & 3)

EXAMPLE: .50 (12.70) HEX, CLASS 3, "A" = .50 (12.70) HEIGHT, C = FLAT NOSE.

• CLH3-78-50C

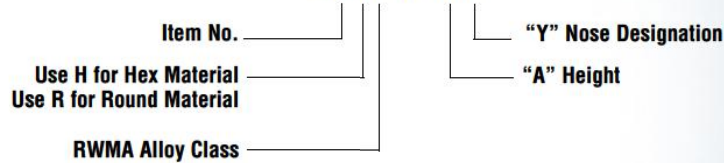

NOTE: Other thread sizes and shapes are available.