

Southern Copper and Supply 800-289-2728
100 SERIES (NON-EJECTOR) WATER COOLED ELECTRODE HOLDER



Phone: 866-634-8884

Fax: 866-239-6995

Email: cmw@cmwinc.com

100 SERIES (NON-EJECTOR) WATER COOLED ELECTRODE HOLDER

100 SERIES TAPERED HOLDER					
Part No. Holder Assy.	Major Taper Dia. A	Barrel Dia. B	Barrel Length C	RW Taper D	Engagement With Std. Elect. E
18-101 18-102 18-103 18-104	.463	3/4 7/8 1 1-1/4	3	4 RW	1/2
18-106 18-107 18-108	.625	1 1-1/4 1-1/2			
18-111 18-112 18-113 18-114	.463	3/4 7/8 1 1-1/4	8	4 RW	1/2
18-116 18-117 18-118	.625	1 1-1/4 1-1/2			
18-119 18-120	.875	1-1/4 1-1/2	12	7 RW	1-1/8
18-131 18-132 18-133 18-134	.463	3/4 7/8 1 1-1/4			
18-136 18-137 18-138	.625	1 1-1/4 1-1/2	12	5 RW	3/4

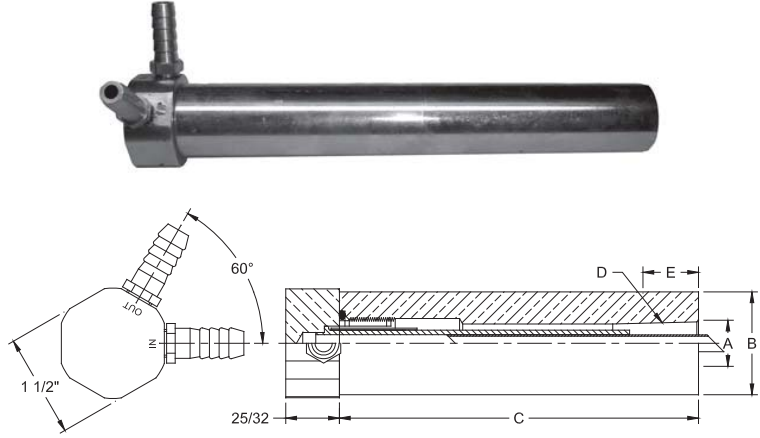

100 SERIES THREADED HOLDER				
Part No. Holder Assy.	Barrel Dia. B	Barrel Length C	Thread Size D	Engagement With Std. Electrode E
18-169 18-170 18-171	1 1-1/4 1-1/2	8	5/8-18	9/16
18-172 18-173 18-174	1 1-1/4 1-1/2			
18-175 18-176	1-1/4 1-1/2	8	1-14	3/4

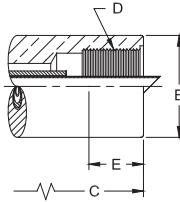

See available adapters in table below.

ADAPTERS USED WITH THREADED HOLDERS

100 SERIES THREADED HOLDER ADAPTERS					
Holder Assembly No.		Adapter Part No.	Page No.	Attachment Description	
18-169 18-170 18-171	Use with	18-750	31	4 RW Female	
		18-751	31	5 RW Female	
		18-752	31	5/8-18 M. Thread	
		18-811	48	#1 Size Nu-Twist®	
18-172 18-173 18-174	Use with	18-770	31	4 RW Female	May also be used with universal Adapters having 7/8-14 Male thread See page 46
		18-771	31	5 RW Female	
18-175 18-176	Use with	18-785	31	4 RW Female	May also be used with universal Adapters having 1-14 Male thread See page 46
		18-786	31	5 RW Female	
		18-7863	31	6 RW Female	
		18-787	31	7 RW Female	
		18-812	48	#2 Size Nu-Twist®	

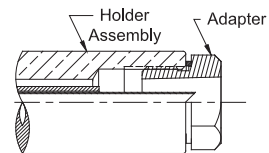
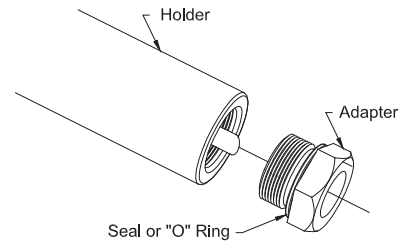

Southern Copper and Supply 800-289-2728
100 SERIES (NON-EJECTOR) REPLACEMENT PARTS



Phone: 866-634-8884

Fax: 866-239-6995

Email: cmw@cmwinc.com

100 SERIES (NON-EJECTOR) WATER COOLED ELECTRODE HOLDER

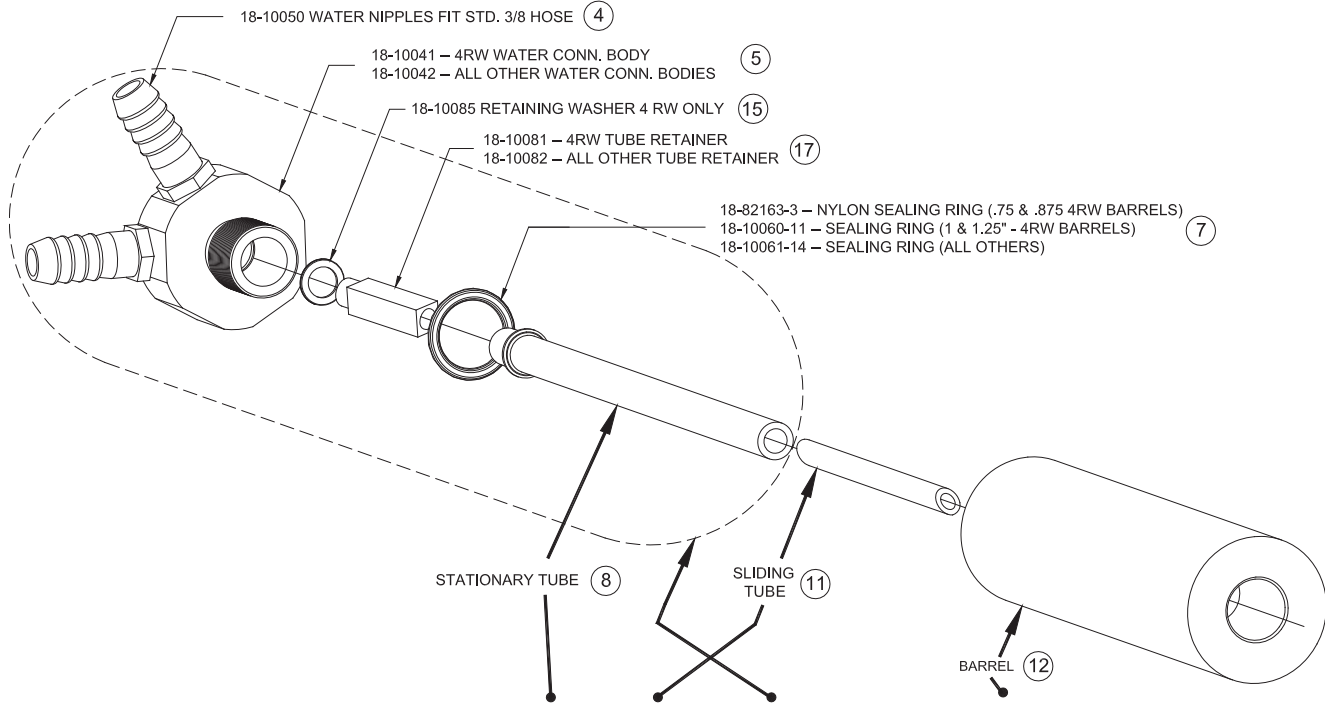

Part No. Holder Assy.	Thread Or Taper	Barrel Length	Stationary Tube	Sliding Tube	Water Conn. HD. Sub-Assy. Include Parts:	Barrel Diameter	Barrel 12
18-101 18-102 18-103 18-104	4 RW	3	18-10044-3	18-10046-3	18-10091-3	3/4 7/8 1 1-1/4	18-11110-3 18-11210-3 18-11310-3 18-11410-3
18-106 18-107 18-108	5 RW	3	18-10045-3	18-10047-3	18-10092-3	1 1-1/4 1-1/2	18-11610-3 18-11710-3 18-11810-3
18-111 18-112 18-113 18-114	4 RW	8	18-10044-8	18-10046-8	18-10091-8	3/4 7/8 1 1-1/4	18-11110-8 18-11210-8 18-11310-8 18-11410-8
18-116 18-117 18-118	5 RW	8	18-10045-8	18-10047-8	18-10092-8	1 1-1/4 1-1/2	18-11610-8 18-11710-8 18-11810-8
18-119 18-120	7 RW	8	18-10045-8	18-10047-8	18-10092-8	1-1/4 1-1/2	18-11910-8 18-12010-8
18-131 18-132 18-133 18-134	4 RW	12	18-10044-12	18-10046-8	18-10091-12	3/4 7/8 1 1-1/4	18-11110-12 18-11210-12 18-11310-12 18-11410-12
18-136 18-137 18-138	5 RW	12	18-10045-12	18-10047-8	18-10092-12	1 1-1/4 1-1/2	18-11610-12 18-11710-12 18-11810-12
18-169 18-170 18-171	5/8-18	8	18-10045-8	18-10047-8	18-10092-8	1 1-1/4 1-1/2	18-16910-8 18-17010-8 18-17110-8
18-172 18-173 18-174	7/8-14	8	18-10045-8	18-10047-8	18-10092-8	1 1-1/4 1-1/2	18-17210-8 18-17310-8 18-17410-8
18-175 18-176	1-14	8	18-10045-8	18-10047-8	18-10092-8	1-1/4 1-1/2	18-17510-8 18-17610-8

Southern Copper and Supply 800-289-2728
200 SERIES (EJECTOR) WATER COOLED ELECTRODE HOLDER



Phone: 866-634-8884

Fax: 866-239-6995

Email: cmw@cmwinc.com

200 SERIES (EJECTOR) WATER COOLED ELECTRODE HOLDER

200 SERIES TAPERED HOLDER								
Part No. Holder Assy.	Major Taper Dia. A	Barrel Dia. B	Barrel Length C	RW Taper D	Engagement With Std. Elect. E			
18-201 18-202 18-203 18-204	.463	3/4 7/8 1 1-1/4	3	4 RW	1/2			
18-206 18-207 18-208	.625	1 1-1/4 1-1/2				5 RW	3/4	
18-211 18-212 18-213 18-214	.463	3/4 7/8 1 1-1/4				8	4 RW	1/2
18-216 18-217 18-218	.625	1 1-1/4 1-1/2						
18-219* 18-220*	.875	1-1/4 1-1/2	7 RW	1-1/8				
18-231 18-232 18-233 18-234	.463	3/4 7/8 1 1-1/4	12	4 RW	1/2			
18-236 18-237 18-238	.625	1 1-1/4 1-1/2				5 RW	3/4	
18-236-18 18-237-18 18-238-18	.625	1 1-1/4 1-1/2				18	5 RW	3/4

*Must use knockout adapter 18-20033

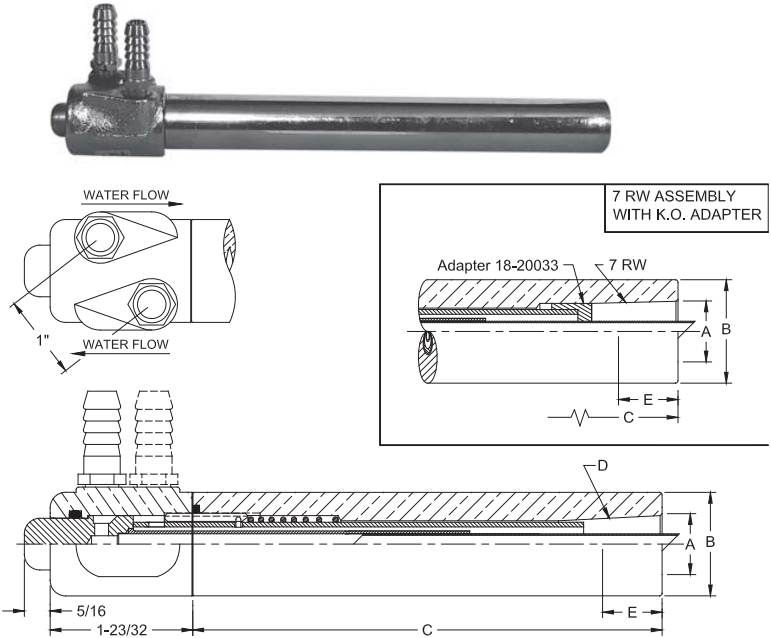

200 SERIES THREADED HOLDER						
Part No. Holder Assy.	Barrel Dia. B	Barrel Length C	Thread Size D	Engagement With Std. Elect. E		
18-272 18-273 18-274	1 1-1/4 1-1/2	8	7/8-14	9/16		
18-275 18-276	1-1/4 1-1/2				1-14	3/4

200 Series Threaded Holder can use Male Threaded to Female Taper Universal Adapters on page 46.

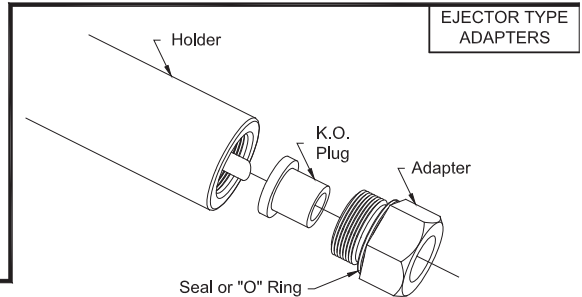
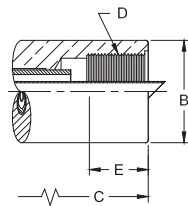

EJECTOR TYPE ADAPTERS

EJECTOR TYPE ADAPTERS 7/8-14 THREAD								
Adapter Part No.	Male Thd. Size L	Female Taper		Length Under Hd. M	Hex. Over Flats H	Overall Length C	Sealing Ring Part No.	K.O. Plug Part No.
		Size D	Major Dia. A					
18-7702	7/8-14	4 RW	.463	5/8	1	13/16	18-76460	18-78501
18-7712	7/8-14	5 RW	.625	1/2	1	1-1/16	18-76460	18-7712-3

Use with Threaded Ejector Holder to make Replaceable Taper Holders

Part No.	Female Thd. Size	Barrel Dia.
18-272	7/8-14	1
18-273	7/8-14	1-1/4
18-274	7/8-14	1-1/2

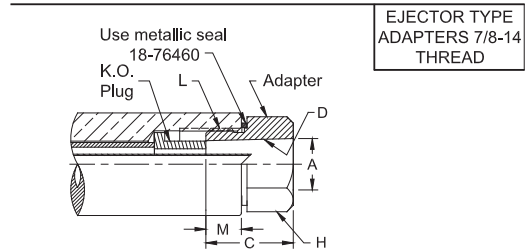

EJECTOR TYPE ADAPTERS 1-14 THREAD								
Adapter Part No.	Male Thd. Size L	Female Taper		Length Under Hd. M	Hex. Over Flats H	Overall Length C	Sealing Ring Part No.	K.O. Plug Part No.
		Size D	Major Dia. A					
18-7852	1-14	4 RW	.463	9/16	1-1/4	13/16	18-10060-17	18-78501
18-7862	1-14	5 RW	.625	7/16	1-1/4	1-1/16	18-10060-17	18-7712-3
18-7864	1-14	6 RW	.750	3/4	1-1/4	1-3/4	18-10060-17	18-78650
18-7872	1-14	7 RW	.875	3/4	1-1/4	2-1/8	18-10060-17	18-78701

Use with Threaded Ejector Holder to make Replaceable Taper Holders

Part No.	Female Thd. Size	Barrel Dia.
18-275	1-14	1-1/4
18-276	1-14	1-1/2

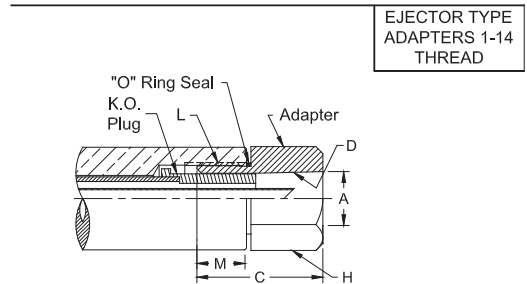

Southern Copper and Supply 800-289-2728

200 SERIES (EJECTOR) REPLACEMENT PARTS



Phone: 866-634-8884

Fax: 866-239-6995

Email: cmw@cmwinc.com

200 SERIES (EJECTOR) WATER COOLED ELECTRODE HOLDER

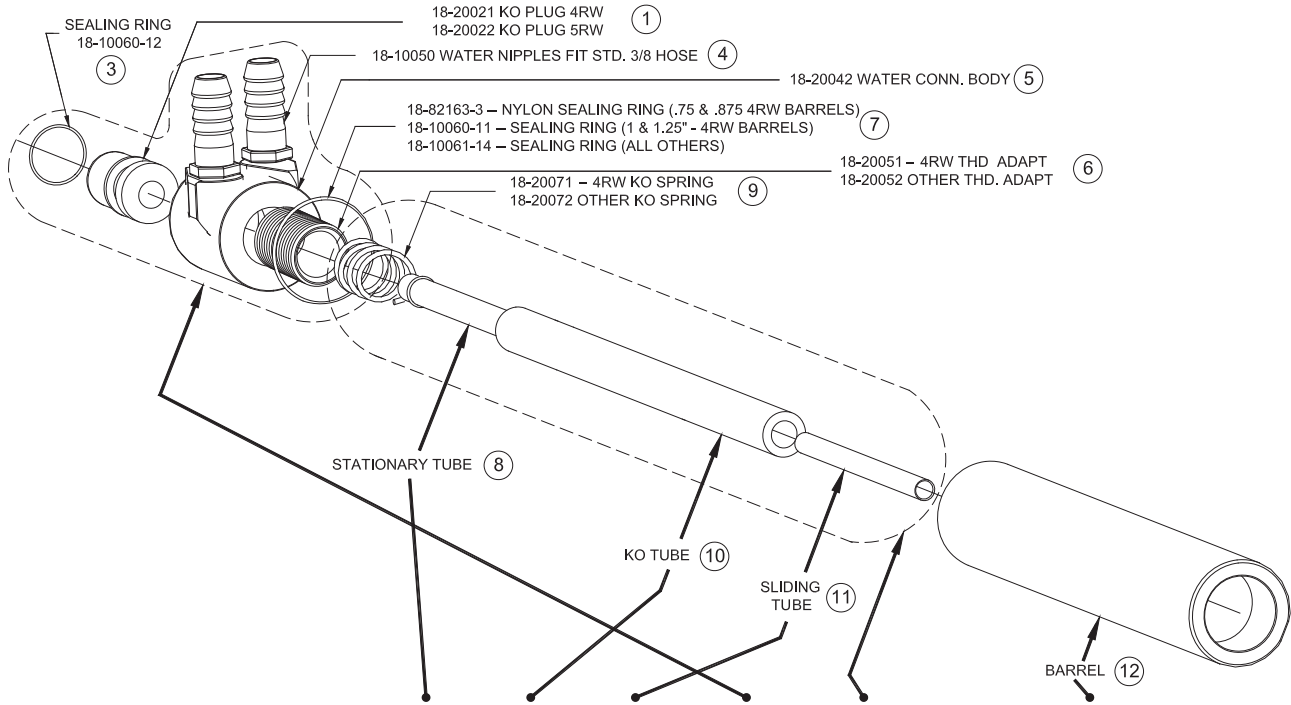

Part No. Holder Assy.	Thread Or Taper	Barrel Length	Stationary Tube 8	K.O. Tube 10	Sliding Tube 11	Water Conn. HD. Sub-Assy. Include Parts: 1 3 4 5 6 7	K.O. Tube Sub-Assy Include Parts: 8 9 10 11	Barrel Diameter	Barrel 12
18-201 18-202 18-203 18-204	4 RW	3	18-10044-3	18-20031-3	18-10046-3	18-20091	18-20095-3	3/4 7/8 1 1-1/4	18-11110-3 18-11210-3 18-11310-3 18-11410-3
18-206 18-207 18-208	5 RW	3	18-10045-3	18-20032-3	18-10047-3	18-20092	18-20096-3	1 1-1/4 1-1/2	18-11610-3 18-11710-3 18-11810-3
18-211 18-212 18-213 18-214	4 RW	8	18-10044-8	18-20031-8	18-10046-8	18-20091	18-20095-8	3/4 7/8 1 1-1/4	18-11110-8 18-11210-8 18-11310-8 18-11410-8
18-216 18-217 18-218	5 RW	8	18-10045-8	18-20032-8	18-10047-8	18-20092	18-20096-8	1 1-1/4 1-1/2	18-11610-8 18-11710-8 18-11810-8
18-219* 18-220*	7 RW	8	18-10045-8	18-20032-58 & 18-20033*	18-10047-8	18-20092	18-20096-58	1-1/4 1-1/2	18-11910-8 18-12010-8
18-231 18-232 18-233 18-234	4 RW	12	18-10044-12	18-20031-12	18-10046-8	18-20091	18-20095-12	3/4 7/8 1 1-1/4	18-11110-12 18-11210-12 18-11310-12 18-11410-12
18-236 18-237 18-238	5 RW	12	18-10045-12	18-20032-12	18-10047-8	18-20092	18-20096-12	1 1-1/4 1-1/2	18-11610-12 18-11710-12 18-11810-12
18-236-18 18-237-18 18-238-18	5 RW	18	18-10045-12	18-20032-18	18-10047-29	18-20092	18-20096-18	1 1-1/4 1-1/2	18-11610-18 18-11710-18 18-11810-18
18-272 18-273 18-274	7/8-14	8	18-10045-8	18-20032-8	18-10047-8	18-20092	18-20096-8	1 1-1/4 1-1/2	18-17210-8 18-17310-8 18-17410-8
18-275 18-276	1-14	8	18-10045-8	18-20032-8	18-10047-8	18-20092	18-20096-8	1-1/4 1-1/2	18-17510-8 18-17610-8

*Must use knockout adapter 18-20033

Southern Copper and Supply 800-289-2728

300 SERIES PREMIUM (EJECTOR) WATER COOLED ELECTRODE HOLDERS



Phone: 866-634-8884

Fax: 866-239-6995

Email: cmw@cmwinc.com

300 SERIES PREMIUM (EJECTOR) WATER COOLED ELECTRODE HOLDER

CMW Premium holder barrels are made from high strength CMW®3 material, centerless ground within .002" tolerance on diameter and nickel plated to resist wear and assure uniform contact resistance of a low magnitude



300 SERIES TAPERED HOLDER					
Part No. Holder Assy.	Major Taper Dia. A	Barrel Dia. B	Barrel Length C	RW Taper D	Engagement With Std. Elect. E
18-317 18-318	.625	1-1/4 1-1/2	8	5 RW	3/4
18-319* 18-320*	.875	1-1/4 1-1/2		7 RW	1-1/8
18-337 18-338	.625	1-1/4 1-1/2	12	5 RW	3/4
18-339* 18-340*	.875	1-1/4 1-1/2		7 RW	1-1/8

*Must use knockout adapter 18-20033

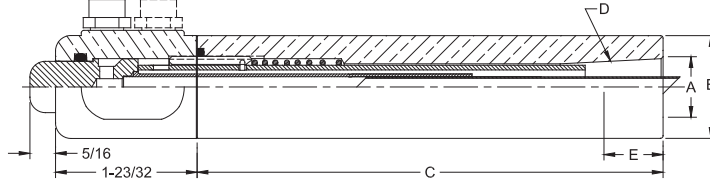
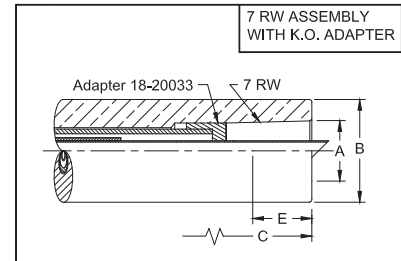
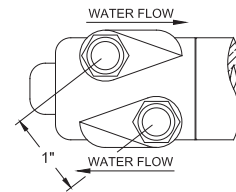

300 SERIES THREADED HOLDER				
Part No. Holder Assy.	Barrel Dia. B	Barrel Length C	Thread Size D	Engagement With Std. Elect. E
18-372 18-373	1 1-1/4	8	7/8-14	9/16
18-375 18-376	1-1/4 1-1/2		1-14	3/4

300 Series Threaded Holder can use Male Threaded to Female Taper Universal Adapters on page 46.

Note: These threaded holder barrels are the same as on 600 series holders on page 44.

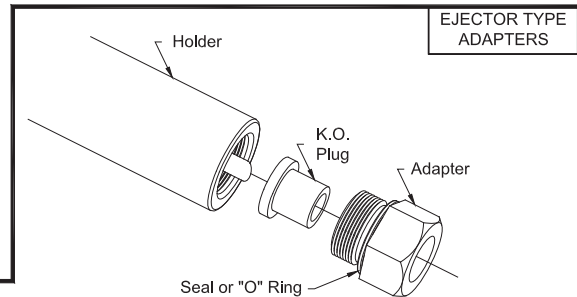
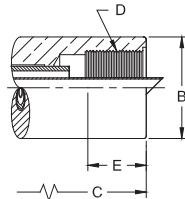

EJECTOR TYPE ADAPTERS

EJECTOR TYPE ADAPTERS 7/8-14 THREAD								
Adapter Part No.	Male Thd. Size L	Female Taper Size D Major Dia.		Length Under Hd. M	Hex. Over Flats H	Overall Length C	Sealing Ring Part No.	K.O. Plug Part No.
18-7702	7/8-14	4 RW	.463	5/8	1	13/16	18-76460	18-78501
18-7712	7/8-14	5 RW	.625	1/2	1	1-1/16	18-76460	18-7712-3

Use with Threaded Ejector Holder to make Replaceable Taper Holders

Part No.	Female Thd. Size	Barrel Dia.
18-372	7/8-14	1
18-373	7/8-14	1-1/4

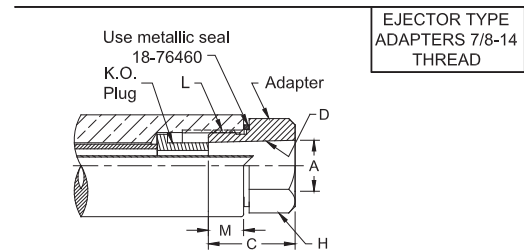

EJECTOR TYPE ADAPTERS 1-14 THREAD								
Adapter Part No.	Male Thd. Size L	Female Taper Size D Major Dia.		Length Under Hd. M	Hex. Over Flats H	Overall Length C	Sealing Ring Part No.	K.O. Plug Part No.
18-7852	1-14	4 RW	.463	9/16	1-1/4	13/16	18-10060-17	18-78501
18-7862	1-14	5 RW	.625	7/16	1-1/4	1-1/16	18-10060-17	18-7712-3
18-7864	1-14	6 RW	.750	3/4	1-1/4	1-3/4	18-10060-17	18-78650
18-7872	1-14	7 RW	.875	3/4	1-1/4	2-1/8	18-10060-17	18-78701

Use with Threaded Ejector Holder to make Replaceable Taper Holders

Part No.	Female Thd. Size	Barrel Dia.
18-375	1-14	1-1/4
18-376	1-14	1-1/2

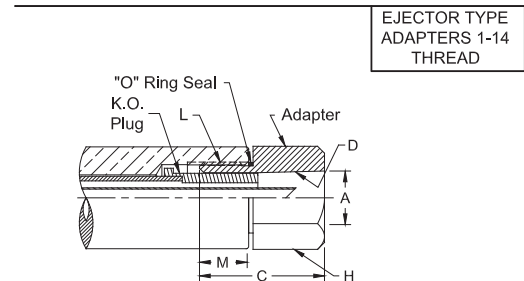

Southern Copper and Supply 800-289-2728
300 SERIES PREMIUM (EJECTOR) REPLACEMENT PARTS



Phone: 866-634-8884

Fax: 866-239-6995

Email: cmw@cmwinc.com

300 SERIES PREMIUM (EJECTOR) WATER COOLED ELECTRODE HOLDER

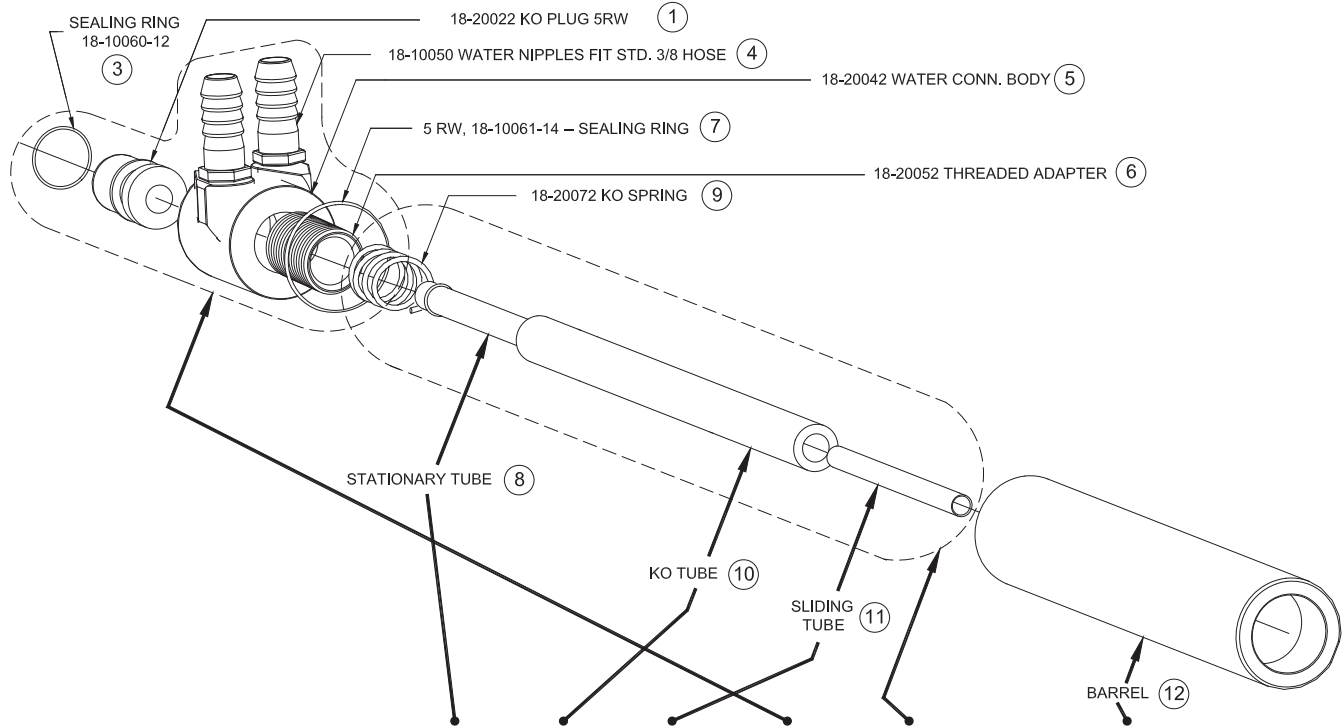

Part No. Holder Assy.	Thread Or Taper	O.A.L	Stationary Tube 8	K.O. Tube 10	Sliding Tube 11	Water Conn. HD. Sub-Assy. Include Parts: 1 3 4 5 6 7	K.O. Tube Sub-Assy Include Parts: 8 9 10 11	Barrel Diameter	Barrel 12
18-317 18-318	5 RW	8	18-10045-8	18-20032-8	18-10047-8	18-20092	18-20096-8	1-1/4 1-1/2	18-31710-8 18-31810-8
18-319* 18-320*	7 RW	8	18-10045-8	18-20032-58 & 18-20033*	18-10047-8	18-20092	18-20096-58	1-1/4 1-1/2	18-31910-8 18-32010-8
18-337 18-338	5 RW	12	18-10045-12	18-20032-12	18-10047-8	18-20092	18-20096-12	1-1/4 1-1/2	18-31710-12 18-31810-12
18-339* 18-340*	7 RW	12	18-10045-12	18-20032-62 & 18-20033*	18-10047-8	18-20092	18-20096-62	1-1/4 1-1/2	18-31910-12 18-32010-12
18-372 18-373	7/8-14	8	18-10045-8	18-20032-8	18-10047-8	18-20092	18-20096-8	1 1-1/4	18-37210-8 18-37310-8
18-375 18-376	1-14	8	18-10045-8	18-20032-8	18-10047-8	18-20092	18-20096-8	1-1/4 1-1/2	18-37510-8 18-37610-8

*Must use knockout adapter 18-20033

Southern Copper and Supply 800-289-2728
TYPICAL SET-UP COMBINATIONS USING CMW WELDING PRODUCTS



Phone: 866-634-8884

Fax: 866-239-6995

Email: cmw@cmwinc.com

**COMBINATIONS OF CMW
 HOLDERS, ADAPTERS AND
 ELECTRODES CAN
 PERFORM MOST RESISTANCE
 WELDING APPLICATIONS**

Many of these combinations make possible welding operations that could have been done heretofore only by the use of "expensive and special" holders and electrodes. A few ideas of the many possible combinations are shown for your guidance.

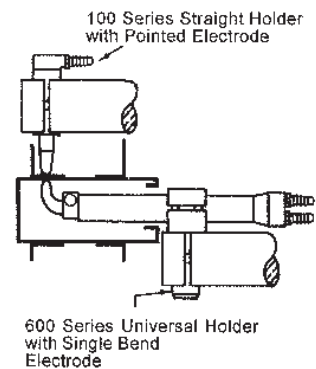
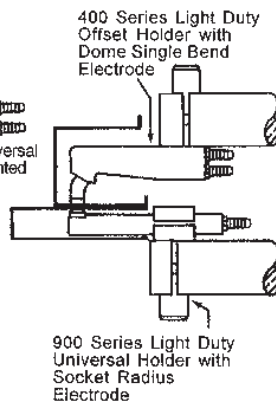
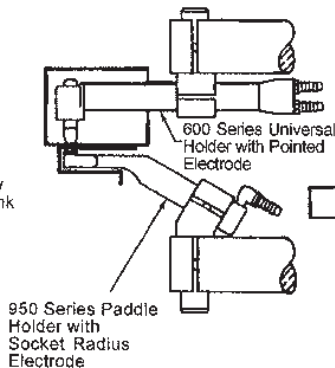
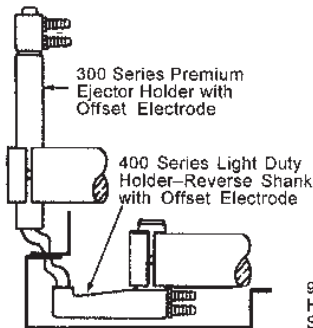
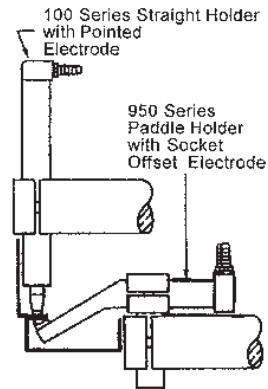
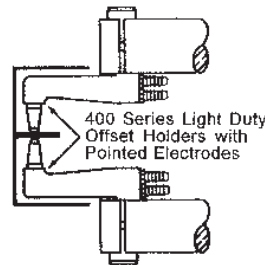
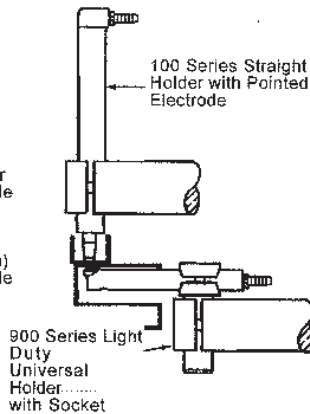
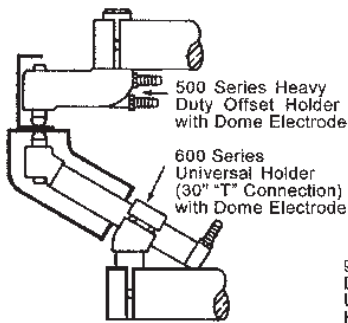
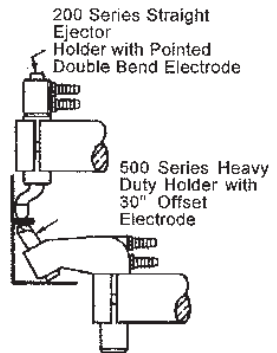
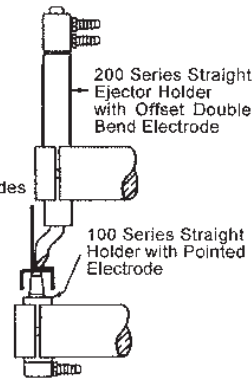
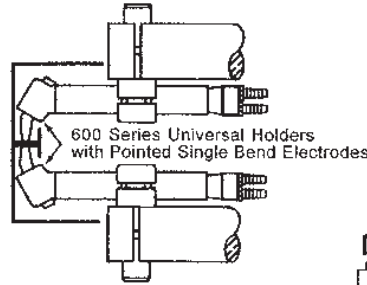
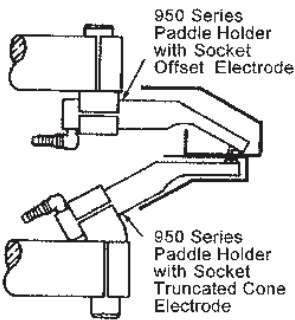
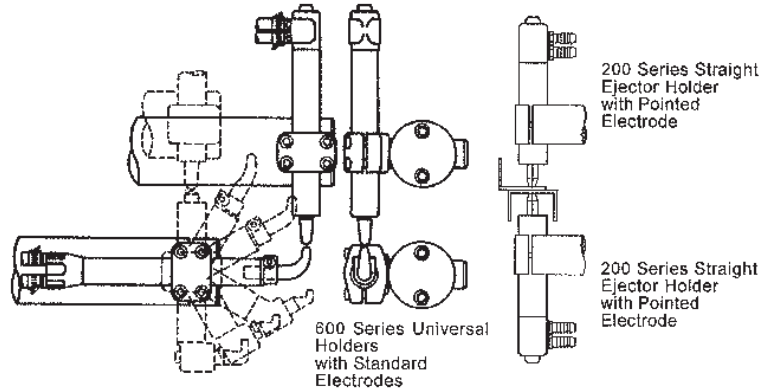

400 SERIES OFFSET (NON-EJECTOR) WATER COOLED ELECTRODE HOLDERS



Phone: 866-634-8884

Fax: 866-239-6995

Email: cmw@cmwinc.com

400 SERIES OFFSET (NON-EJECTOR) WATER COOLED ELECTRODE HOLDERS

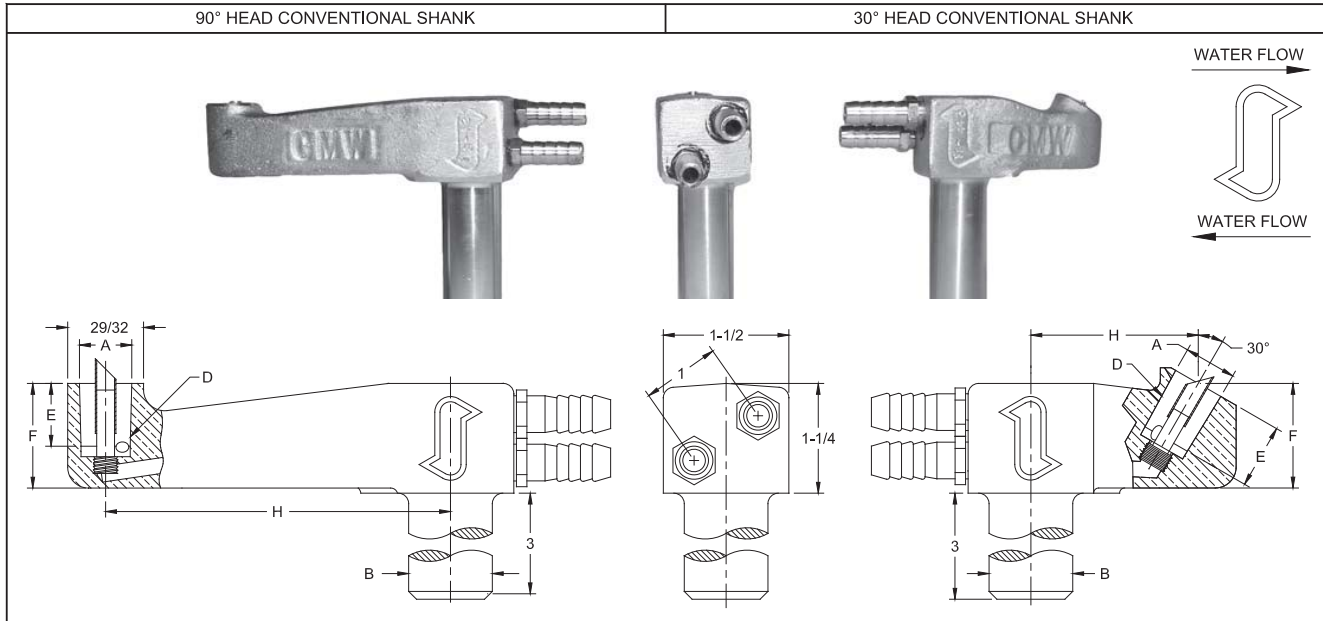

400 SERIES OFFSET HOLDER (CONVENTIONAL SHANK 90°)						
Part No. Holder Assy.	Major Taper Dia. A*	Shank Dia. B*	RW Taper D	Engagement With Electrode E	Head Height F	Offset H
18-402	.463	7/8	4 RW	1/2	1-1/16	2
18-403		1				
18-404		1-1/4				
18-407	.625	7/8	5 RW	3/4	1-1/4	2
18-408		1				
18-409		1-1/4				
18-422	.463	7/8	4 RW	1/2	1-1/16	4
18-423		1				
18-424		1-1/4				
18-428	.625	1	5 RW	3/4	1-1/4	4
18-429		1-1/4				

400 SERIES OFFSET HOLDER (CONVENTIONAL SHANK 30°)						
Part No. Holder Assy.	Major Taper Dia. A*	Shank Dia. B*	RW Taper D	Engagement With Electrode E	Head Height F	Offset H
18-442	.463	7/8	4 RW	1/2	1	2
18-443		1				
18-444		1-1/4				
18-448	.625	1	5 RW	3/4	1-1/4	2
18-449		1-1/4				
18-462	.463	7/8	4 RW	1/2	1	4
18-463		1				
18-464		1-1/4				
18-468	.625	1	5 RW	3/4	1-1/4	4
18-469		1-1/4				

*Other shank diameters and lengths or tapers available on special order

*Other shank diameters and lengths or tapers available on special order

400 SERIES OFFSET (NON-EJECTOR) WATER COOLED ELECTRODE HOLDERS

90° HEAD REVERSE SHANK

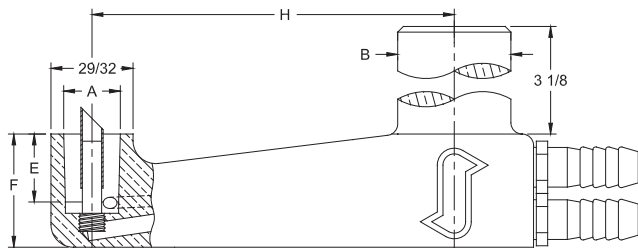

400 SERIES OFFSET HOLDER (REVERSE SHANK 90°)						
Part No. Holder Assy.	Major Taper Dia. A*	Shank Dia. B*	RW Taper D	Engagement With Electrode E	Head Height F	Offset H
18-433	.463	1	4 RW	1/2	1-1/16	4
18-439	.625	1-1/4	5 RW	3/4	1-1/4	4

*Other shank diameters and lengths or tapers available on special order



Southern Copper and Supply 800-289-2728
400 SERIES OFFSET (NON-EJECTOR) REPLACEMENT PARTS



Phone: 866-634-8884

Fax: 866-239-6995

Email: cmw@cmwinc.com

400 SERIES OFFSET (NON-EJECTOR) REPLACEMENT PARTS

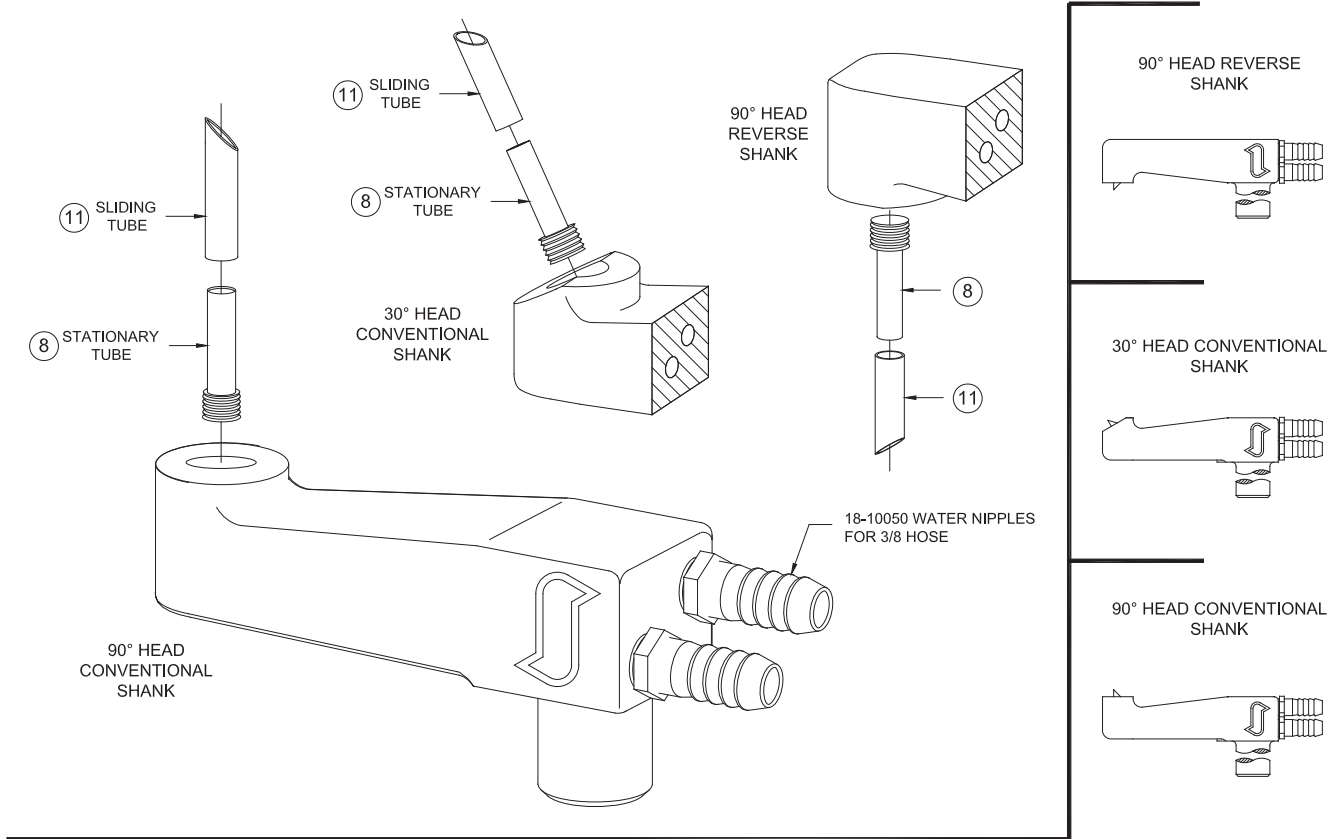

Part No. Holder Assy.	Taper	Angle Of Head	Stationary Tube 8	Sliding Tube 11	Shank Dia.
18-402	4 RW	90°	18-40041-1	18-40043-1	7/8
18-403					1
18-404					1-1/4
18-407	5 RW	90°	18-40041-1	18-40043-2	7/8
18-408					1
18-409					1-1/4
18-422	4 RW	90°	18-40041-1	18-40043-1	7/8
18-423					1
18-424					1-1/4
18-433*					1
18-428	5 RW	90°	18-40041-1	18-40043-2	1
18-429					1-1/4
18-439*					1-1/4
18-442	4 RW	30°	18-40041-1	18-40043-1	7/8
18-443					1
18-444					1-1/4
18-448	5 RW	30°	18-40041-1	18-40043-2	1
18-449					1-1/4
18-462	4 RW	30°	18-40041-1	18-40043-1	7/8
18-463					1
18-464					1-1/4
18-468	5 RW	30°	18-40041-1	18-40043-2	1
18-469					1-1/4

*Reverse shank

500 SERIES PREMIUM (EJECTOR) WATER COOLED OFFSET HOLDERS



Phone: 866-634-8884

Fax: 866-239-6995

Email: cmw@cmwinc.com

500 SERIES PREMIUM (EJECTOR) WATER COOLED OFFSET HOLDERS

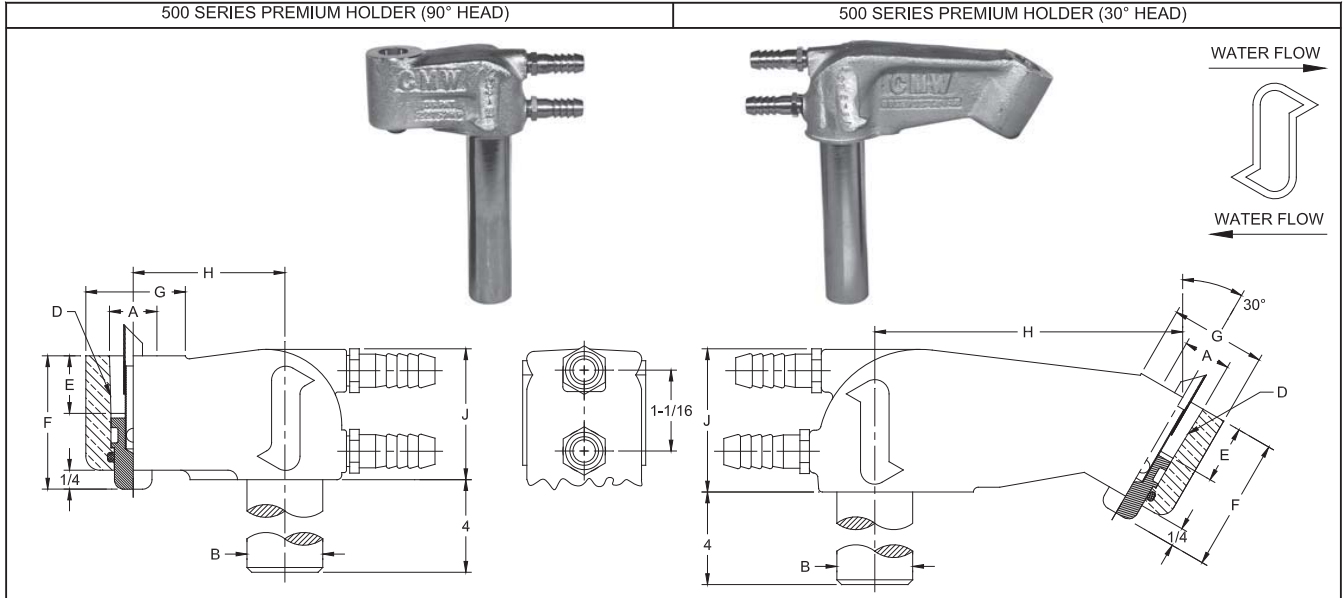

500 SERIES PREMIUM HOLDER (90° HEAD)								
Part No. Holder Assy.	Major Taper Dia. A*	Shank Dia. B*	RW Taper D	Engagement With Electrode E	Head Height F	Head Dia. G	Offset H	Head Thickness J
18-502		1						
18-503	.625	1-1/4	5 RW	3/4	1-13/16	1-1/4	2	1-23/32
18-504		1-1/2						
18-505	.875	1-1/4	7 RW	1-1/8	2-7/32	1-1/2	2	1-23/32
18-506		1-1/2						
18-522		1						
18-523	.625	1-1/4	5 RW	3/4	1-13/16	1-1/4	4	1-7/8
18-524		1-1/2						
18-525	.875	1-1/4	7 RW	1-1/8	2-7/32	1-1/2	4	1-7/8
18-526		1-1/2						

500 SERIES PREMIUM HOLDER (30° HEAD)								
Part No. Holder Assy.	Major Taper Dia. A*	Shank Dia. B*	RW Taper D	Engagement With Electrode E	Head Height F	Head Dia. G	Offset H	Head Thickness J
18-562		1						
18-563	.625	1-1/4	5 RW	3/4	1-13/16	1-5/16	4	1-7/8
18-564		1-1/2						
18-565	.875	1-1/4	7 RW	1-1/8	2-7/32	1-9/16	4	1-7/8
18-566		1-1/2						

*Other shank diameters and lengths or tapers available on special order

*Other shank diameters and lengths or tapers available on special order

500 SERIES PREMIUM (EJECTOR) WATER COOLED ELECTRODE HOLDERS WITH THREADED ADAPTERS

500 SERIES PREMIUM HOLDER WITH THREADED ADAPTERS										
Part No. Holder Assy.	Head Angle	Major Taper Dia. A*	Shank Dia. B*	RW Taper D	Engagement With Electrode E	Head Height F	Head Dia. G	Offset H	Head Thickness J	Part No. Threaded Adapter
18-5035	90°	.625	1-1/4	5 RW	3/4	1-13/16	1-1/4	2	1-23/32	18-7875
18-5036		.750		6 RW	7/8	1-15/16				18-7876
18-5045	90°	.625	1-1/2	5 RW	3/4	1-13/16	1-1/4	2	1-23/32	18-7875
18-5046		.750		6 RW	7/8	1-15/16				18-7876
18-5235	90°	.625	1-1/4	5 RW	3/4	1-13/16	1-1/4	4	1-7/8	18-7875
18-5236		.750		6 RW	7/8	1-15/16				18-7876
18-5245	90°	.625	1-1/2	5 RW	3/4	1-13/16	1-1/4	4	1-7/8	18-7875
18-5246		.750		6 RW	7/8	1-15/16				18-7876
18-5635	30°	.625	1-1/4	5 RW	3/4	1-13/16	1-1/4	4	1-7/8	18-7875
18-5636		.750		6 RW	7/8	1-15/16				18-7876
18-5645	30°	.625	1-1/2	5 RW	3/4	1-13/16	1-1/4	4	1-7/8	18-7875
18-5646		.750		6 RW	7/8	1-15/16				18-7876

*Other shank diameters and lengths or tapers available on special order

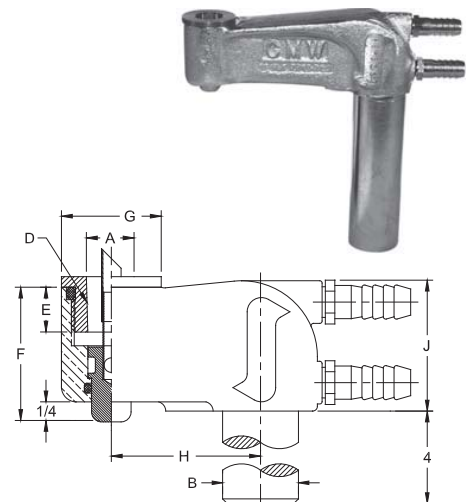

Southern Copper and Supply 800-289-2728
500 SERIES PREMIUM (EJECTOR) REPLACEMENT PARTS



Phone: 866-634-8884

Fax: 866-239-6995

Email: cmw@cmwinc.com

500 SERIES PREMIUM (EJECTOR) WATER COOLED OFFSET HOLDERS

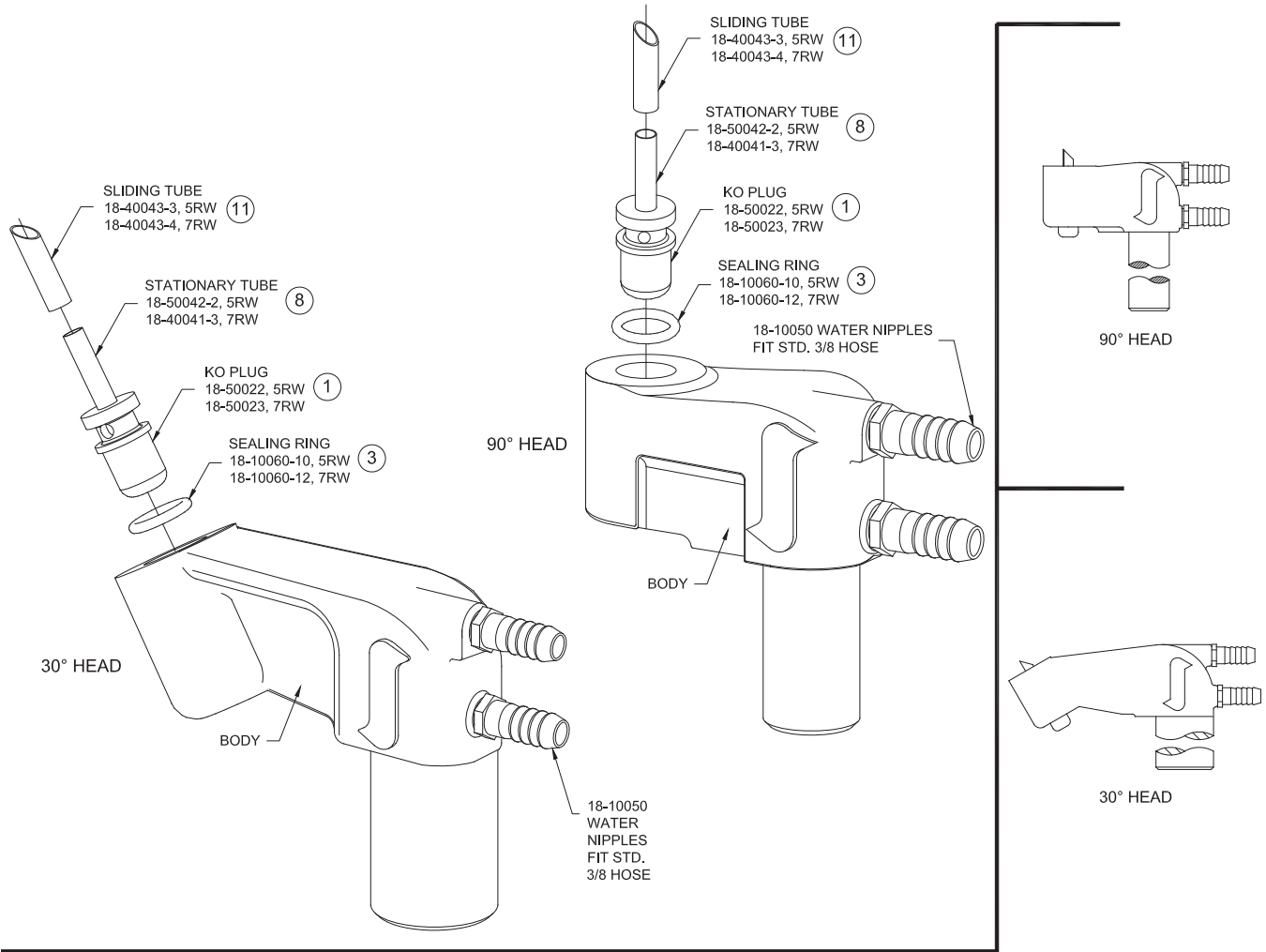

Part No. Holder Assy.	Taper	Angle Of Head	KO Plug 1	Sealing Ring 3	Stationary Tube 8	Sliding Tube 11	Shank Dia.
18-502 18-503 18-504	5 RW	90°	18-50022	18-10060-10	18-50042-2	18-40043-3	1 1-1/4 1-1/2
18-505 18-506	7 RW	90°	18-50023	18-10060-12	18-40041-3	18-40043-4	1-1/4 1-1/2
18-522 18-523 18-524	5 RW	90°	18-50022	18-10060-10	18-50042-2	18-40043-3	1 1-1/4 1-1/2
18-525 18-526	7 RW	90°	18-50023	18-10060-12	18-40041-3	18-40043-4	1-1/4 1-1/2
18-562 18-563 18-564	5 RW	30°	18-50022	18-10060-10	18-50042-2	18-40043-3	1 1-1/4 1-1/2
18-565 18-566	7 RW	30°	18-50023	18-10060-12	18-40041-3	18-40043-4	1-1/4 1-1/2



Phone: 866-634-8884

Fax: 866-239-6995

Email: cmw@cmwinc.com

500 SERIES PREMIUM (EJECTOR) WATER COOLED OFFSET HOLDERS WITH THREADED ADAPTER

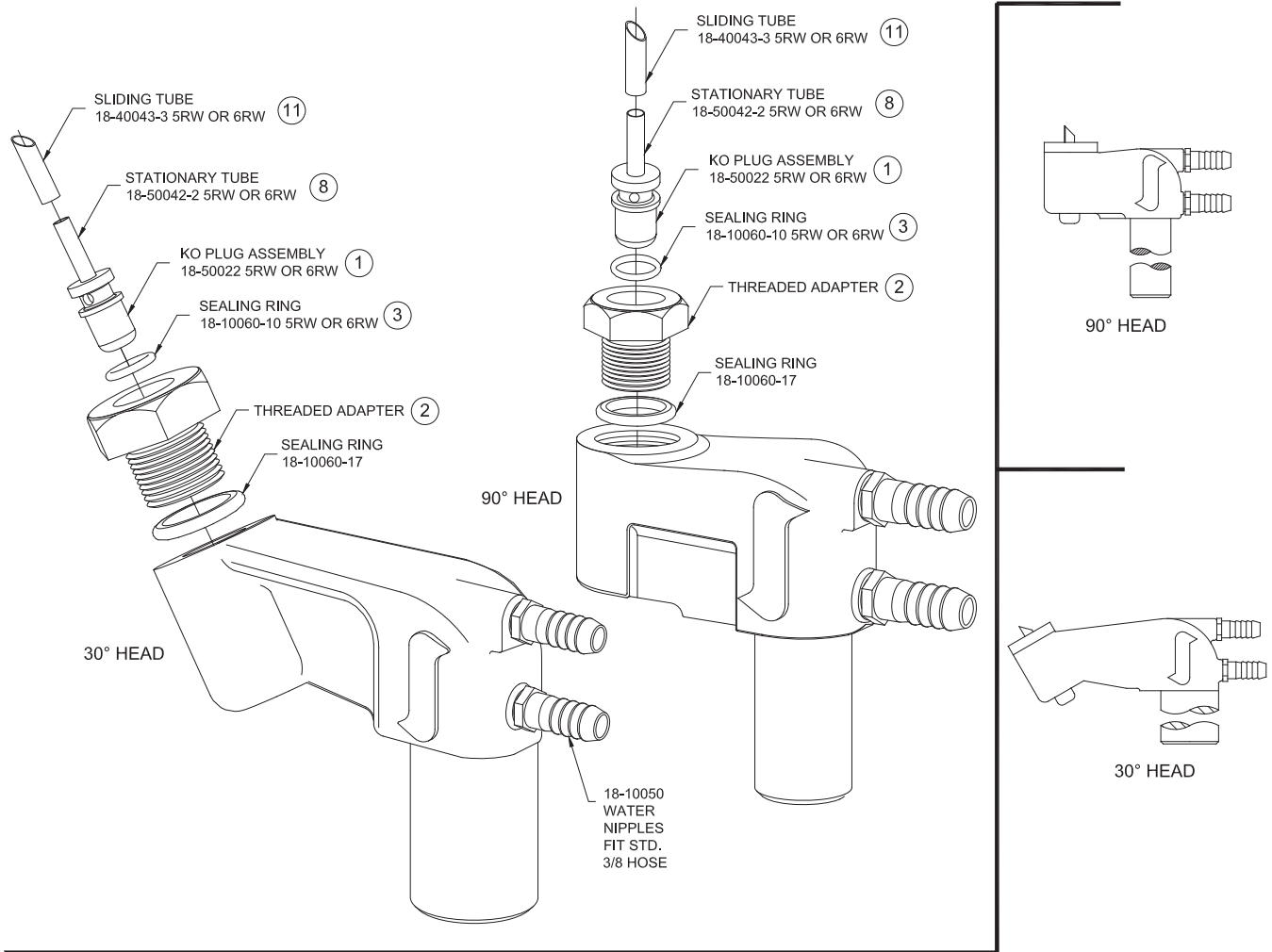

Part No. Holder Assy.	Taper	Angle Of Head	KO Plug ** 1	Sealing Ring 3	Stationary Tube 8	Sliding Tube 11	Shank Dia.	Threaded Adapter* 2
18-5035 18-5036	5 RW 6 RW	90°	18-50022	18-10060-10	18-50042-2	18-40043-3	1-1/4	18-7875 18-7876
18-5045 18-5046	5 RW 6 RW	90°	18-50022	18-10060-10	18-50042-2	18-40043-3	1-1/2	18-7875 18-7876
18-5235 18-5236	5 RW 6 RW	90°	18-50022	18-10060-10	18-50042-2	18-40043-3	1-1/4	18-7875 18-7876
18-5245 18-5246	5 RW 6 RW	90°	18-50022	18-10060-10	18-50042-2	18-40043-3	1-1/2	18-7875 18-7876
18-5635 18-5636	5 RW 6 RW	30°	18-50022	18-10060-10	18-50042-2	18-40043-3	1-1/4	18-7875 18-7876
18-5645 18-5646	5 RW 6 RW	30°	18-50022	18-10060-10	18-50042-2	18-40043-3	1-1/2	18-7875 18-7876

* Threaded adapter includes sealing ring 18-10060-17
 ** KO Plug assembly includes stationary tube 18-50042-2

Southern Copper and Supply 800-289-2728
600 SERIES UNIVERSAL WATER COOLED ELECTRODE HOLDERS



Phone: 866-634-8884

Fax: 866-239-6995

Email: cmw@cmwinc.com

600 SERIES UNIVERSAL WATER COOLED ELECTRODE HOLDERS

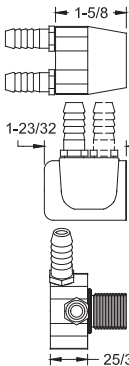
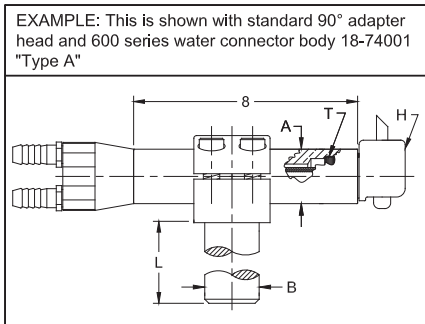

TYPE (A)
600 Series Water Connector Body 18-74001

TYPE (B)
200 Series Water Connector Body 18-20042-1

TYPE (C)
100 Series Water Connector Body 18-10042

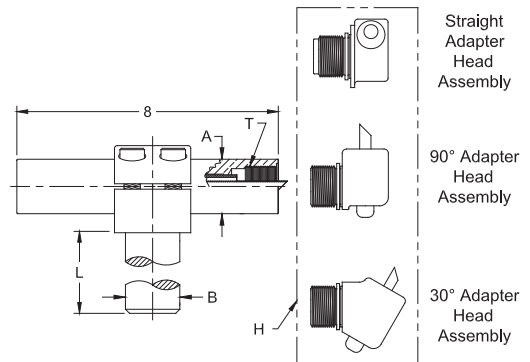

*Standard holders include type "A" water connector, types "B" and "C" available on request
 See page 46 for adapter head details and page 47 for additional "T" connector information.



600 SERIES UNIVERSAL HOLDER (90° ADAPTER HEAD)						
Part No. Holder Assy.*	Taper	Barrel Dia. A	Shank Dia B	Shank Length L	Head Assy. H	Barrel Thread Size T
18-601	4 RW	1	7/8	3	18-764	7/8-14
18-603		1	1	3		
18-605	4 RW	1-1/4	1-1/4	3-1/2	18-764	7/8-14
18-607		1-1/4	1-1/2	4		
18-611	5 RW	1	7/8	3	18-766	7/8-14
18-613		1	1	3		
18-615	5 RW	1-1/4	1-1/4	3-1/2	18-766	7/8-14
18-617		1-1/2	1-1/2	4		
18-651	5 RW	1-1/4	1-1/4	3-1/2	18-780	1-14
18-657		1-1/4	1-1/2	4		
18-655	5 RW	1-1/2	1-1/4	4	18-780	1-14
18-653		1-1/2	1-1/2	4		
18-661	7 RW	1-1/4	1-1/4	3-1/2	18-782	1-14
18-665		1-1/2	1-1/4	4		
18-663		1-1/2	1-1/2	4		

600 SERIES UNIVERSAL HOLDER (STRAIGHT ADAPTER HEAD)						
Part No. Holder Assy.*	Taper	Barrel Dia. A	Shank Dia B	Shank Length L	Head Assy. H	Barrel Thread Size T
18-621	4 RW	1	7/8	3	18-768	7/8-14
18-622		1	1	3		
18-623	4 RW	1-1/4	1-1/4	3-1/2	18-768	7/8-14
18-671		1-1/4	1-1/4	3-1/2	18-784	1-14
18-624	5 RW	1-1/4	1-1/2	4	18-768	7/8-14
18-674		1-1/4	1-1/2	4	18-784	1-14
18-672	5 RW	1-1/2	1-1/2	4	18-784	1-14
18-673		1-1/2	1-1/4	4		

600 SERIES UNIVERSAL HOLDER (30° ADAPTER HEAD)						
Part No. Holder Assy.*	Taper	Barrel Dia. A	Shank Dia B	Shank Length L	Head Assy. H	Barrel Thread Size T
18-602	4 RW	1	7/8	3	18-765	7/8-14
18-604		1	1	3		
18-606	4 RW	1-1/4	1-1/4	3-1/2	18-765	7/8-14
18-608		1-1/4	1-1/2	4		
18-612	5 RW	1	7/8	3	18-767	7/8-14
18-614		1	1	3		
18-616	5 RW	1-1/4	1-1/4	3-1/2	18-767	7/8-14
18-618		1-1/4	1-1/2	4		
18-652	5 RW	1-1/4	1-1/4	3-1/2	18-781	1-14
18-658		1-1/4	1-1/2	4		
18-656	5 RW	1-1/2	1-1/4	4	18-781	1-14
18-654		1-1/2	1-1/2	4		
18-662	7 RW	1-1/4	1-1/4	3-1/2	18-783	1-14
18-666		1-1/2	1-1/4	4		
18-664		1-1/2	1-1/2	4		

600 SERIES UNIVERSAL WATER COOLED ELECTRODE HOLDER (THREADED ADAPTER HEAD)

600 SERIES UNIVERSAL HOLDER (THREADED ADAPTER HEAD)							
Part No. Holder Assy.*	Taper	Head Angle	Barrel Dia. A	Shank Dia B	Shank Length L	Head Assy. H	Barrel Thread Size T
18-6515	5 RW	90°	1-1/4	1-1/4	3-1/2	18-7805	1-14
18-6535		30°	1-1/2	1-1/2	4		
18-6525	5 RW	30°	1-1/4	1-1/4	3-1/2	18-7815	1-14
18-6545		30°	1-1/2	1-1/2	4		
18-6516	6 RW	90°	1-1/4	1-1/4	3-1/2	18-7806	1-14
18-6536		30°	1-1/2	1-1/2	4		
18-6526	6 RW	30°	1-1/4	1-1/4	3-1/2	18-7816	1-14
18-6546		30°	1-1/2	1-1/2	4		

*Standard holders include type "A" water connector, types "B" and "C" available on request

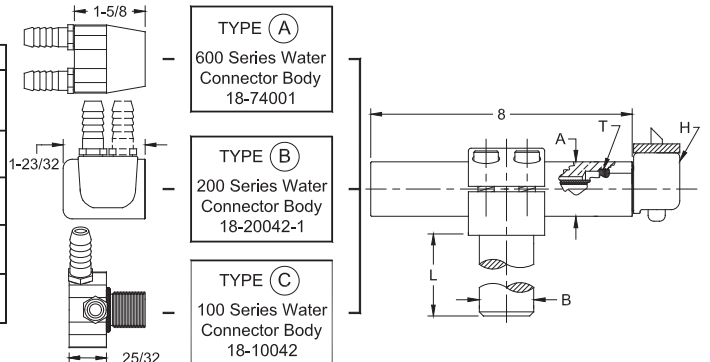

Southern Copper and Supply 800-289-2728

600 SERIES UNIVERSAL REPLACEMENT PARTS



Phone: 866-634-8884

Fax: 866-239-6995

Email: cmw@cmwinc.com

600 SERIES UNIVERSAL WATER COOLED OFFSET HOLDERS

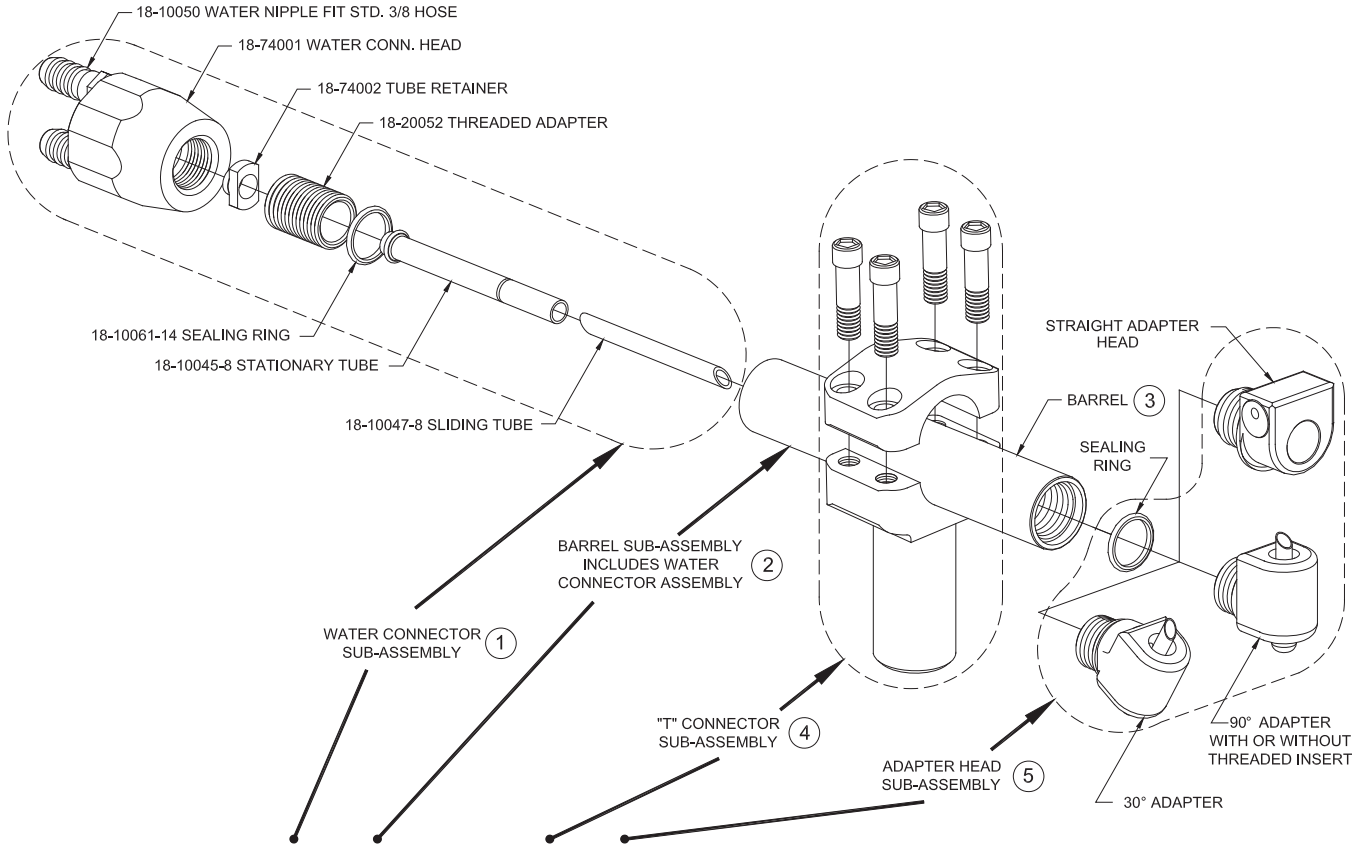

Part No. Holder Assy.	Taper	Angle Of Head	Water Conn. Assy. 1	Barrel Assy. 2	Barrel 3	"T" Conn. Assy. * 4	Adapter Head Assy.* 5
18-601	4 RW	90°	18-74000-8	18-701	18-37210-8	18-725	18-764 18-765
18-602		30°					
18-603		90°	18-74000-8	18-702	18-37310-8	18-727	18-764 18-765
18-604		30°					
18-605	5 RW	90°	18-74000-8	18-701	18-37210-8	18-725	18-766 18-767
18-606		30°					
18-607		90°	18-74000-8	18-702	18-37310-8	18-727	18-766 18-767
18-608		30°					
18-611	7 RW	90°	18-74000-8	18-701	18-37210-8	18-725	18-766 18-767
18-612		30°					
18-613		90°	18-74000-8	18-702	18-37310-8	18-727	18-766 18-767
18-614		30°					
18-615	5 RW	90°	18-74000-8	18-701	18-37210-8	18-725	18-768
18-616		30°					
18-617		90°	18-74000-8	18-702	18-37310-8	18-727	18-768
18-618		30°					
18-621	7 RW	STR.	18-74000-8	18-701	18-37210-8	18-725	18-768
18-622		STR.					
18-623		90°	18-74000-8	18-702	18-37310-8	18-727	18-768
18-624		30°					
18-651	5 RW	90°	18-74000-8	18-704	18-37510-8	18-727	18-780 18-781
18-652		30°					
18-657		90°	18-74000-8	18-704	18-37510-8	18-730	18-780 18-781
18-658		30°					

Part No. Holder Assy.	Taper	Angle Of Head	Water Conn. Assy.* 1	Barrel Assy. 2	Barrel 3	"T" Conn. Assy. * 4	Adapter Head Assy.* 5
18-655	5 RW	90°	18-74000-8	18-705	18-37610-8	18-728	18-780 18-781
18-656		30°					
18-653		90°	18-74000-8	18-704	18-37510-8	18-727	18-784
18-654		30°					
18-671	6 RW	STR.	18-74000-8	18-704	18-37510-8	18-727	18-784
18-672		STR.					
18-673		90°	18-74000-8	18-705	18-37610-8	18-728	18-784
18-674		30°					
18-6515	5 RW THD.	90°	18-74000-8	18-704	18-37510-8	18-727	18-7805 18-7815
18-6525		30°					
18-6535		90°	18-74000-8	18-705	18-37610-8	18-729	18-7805 18-7815
18-6545		30°					
18-6516	6 RW THD.	90°	18-74000-8	18-704	18-37510-8	18-727	18-7806 18-7816
18-6526		30°					
18-6536		90°	18-74000-8	18-705	18-37610-8	18-729	18-7806 18-7816
18-6546		30°					
18-661	7 RW	90°	18-74000-8	18-704	18-37510-8	18-727	18-782 18-783
18-662		30°					
18-665		90°	18-74000-8	18-705	18-37610-8	18-728	18-782 18-783
18-666		30°					
18-663	5 RW	90°	18-74000-8	18-704	18-37510-8	18-727	18-782 18-783
18-664		30°					

* See page 46 for adapter head details and page 47 for additional "T" connector information.